

April 22, 2025

**ADDENDUM NO. 5
TO THE
CONTRACT DOCUMENTS
FOR
CONVENIENCE CENTER & RECYCLING FACILITY CONSTRUCTION
ASSEMBLY COURT SOLID WASTE CONVENIENCE CENTER &
PARKTON SOLID WASTE CONVENIENCE CENTER**

BID ISSUE DATED MARCH 2025

To All Plan Holders:

The following revisions, additions and clarifications are hereby made part of the Contract Documents for the above-referenced project and shall be taken into account in the preparation of all Bids and the execution of all work. Bidders shall acknowledge receipt of the Addendum in the appropriate space on the Proposal Form. Failure to do so may result in your Bid being considered non-responsive.

I. BIDDING AND CONTRACT REQUIREMENTS

A. Bid Form:

Replace the Bid Schedules with the **attached** updated Bid Schedules. Revisions to the Bid Schedules include the following:

Bid Schedule A1. Assembly Court

- Bid Item No. 3 (Embankment) – Estimated quantity updated to 1,600 CY. This value represents embankment to subgrade.
- Bid Item No. 5 (Aggregate Surfacing) – Estimated quantity updated to 5,300 SY.

Bid Schedule A2. Parkton

- Bid Item No. 2 (Excavation) – Estimated quantity updated to 4,300 CY. This value represents excavation to subgrade considering additional excavation needed for paving and aggregate surfacing.
- Bid Item No. 4 (Aggregate Surfacing) – Estimated quantity updated to 8,100 CY.
- New Bid Item No. 6 (Asphalt Paving (Parking Area)) - new bid item for asphalt paving for the parking area has been added.
- All bid items have been renumbered after the addition of new Bid Item No. 6 (Asphalt Paving (Parking Area)).

Addendum No. 5
April 22, 2025
Page 2

II. QUESTIONS AND CLARIFICATIONS

1. Do the volumes noted include the additional cut that may be needed to cut to subgrade for the differing pavement designs or is this additional cut that will need to be allowed for?

Volume for embankment at Assembly Court represents embankment to subgrade. The embankment volume has been adjusted in the base bid schedule to account for the volume required for paving and aggregate surfacing to reach finished grade.

Volume for excavation at Parkton represents excavation to subgrade. The excavation volume has been adjusted in the base bid schedule to account for additional cuts that will be needed for paving and aggregate surfacing to reach finished grade.

*Volume isopachs for both sites comparing existing ground to finished grade are **attached** to this submittal for reference.*

END OF ADDENDUM

Submitted by,
SMITH GARDNER, INC.

DocuSigned by:
Lou J. Krasuski
4FFAB9B6926A4DE...

Lou J. Krasuski
Project Manager
(919) 828-0577 x154
lou@smithgardnerinc.com

DocuSigned by:
Jesse C. Li
C5ECC95C937E4AC...

Jesse C. Li, P.E.
Project Engineer
(919) 828-0577 x170
jesse@smithgardnerinc.com

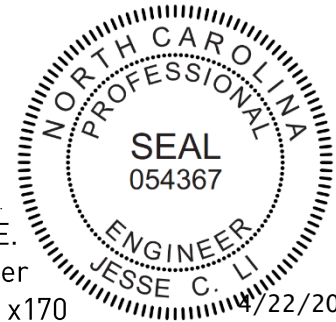

Attachments: Updated Bid Schedules
Volume Isopach – Assembly Court
Volume Isopach - Parkton

Cc: Plan Holders
Stacey A. Smith, P.E., S+G
Spencer W. Hollomon, P.E., S+G
Amanda Lee, P.E., Cumberland County
Johnny Scott, Cumberland County
File

A1. Assembly Court Solid Waste Convenience Center Base Bid Schedule:

Pay Item Number	Description	Spec. Reference	Estimated Quantity ¹	Units	Unit Cost	Extended Cost
1	Site Preparation	02110	2.3	AC		
2	Excavation	02222	500	CY		
3	Embankment	02223	1,600	CY		
4	Over-Excavation & Backfill	02222, 02223	100	CY		
5	Aggregate Surfacing	02500	5,300	SY		
6	Asphalt Paving	02500	1,500	SY		
7	Concrete Paving	03310	200	SY		
8	Drainage Channel: DC-1	02275	245	LF		
9	Drainage Channel: DC-2	02275	200	LF		
10	Drainage Channel: DC-3	02275	250	LF		
11	Infiltration Trench	02270	1	LS	LS	
12	Silt Fence	02270	1,700	LF		
13	Stone Filter Fence	02270	2	EA		
14	Rip Rap Aprons	02271	1	EA		
15	12" Diam. RCP (Class III) (Culvert C-1)	02270	45	LF		
16	Water Line Tap, Installation, & Connection (Pending NCDOT & Fayetteville PWC Approval)	02616	430	LF	LS	
17	Sewer Line Connection & Installation (Pending NCDOT & Fayetteville PWC Approval)	02617	430	LF	LS	
18	Revegetation	02930	1	AC		
19	Vegetative Buffer	-----	575	LF		
20	Chain Link Fence	02820	1,320	LF		

Pay Item Number	Description	Spec. Reference	Estimated Quantity ¹	Units	Unit Cost	Extended Cost
21	Attendant Building Construction	Drawings G101-S201, P101	1	LS	LS	
22	Exterior Light Fixtures	Drawings E1.1-E2.1	4	EA		
23	Electrical (Outdoor)	Drawings E1.1-E2.1	1	LS	LS	
24	Permit Fees & Coordination	-----	1	LS	LS	
25	Surveying Control	-----	1	LS	LS	
26	Bonds, Mobilization & Insurance	-----	1	LS	LS	

The TOTAL BASE BID PRICE for the pay items listed above is as follows:

(In Words) _____ Dollars and _____ Cents.

(In Numbers) (\$ _____.)

Notes:

1. Engineer’s estimated quantities are based on in-place quantities. Areas and lengths are based on horizontally projected areas and lengths. No adjustments have been made for stripping topsoil, slopes, uneven contours, compaction factors, etc.

NOTE: PROPOSAL SIGNATURE REQUIRED ON PAGE P-13. ALL PROPOSALS MUST BE PROPERLY EXECUTED TO BE CONSIDERED A VALID BID.

A2. Parkton Solid Waste Convenience Center Base Bid Schedule:

Pay Item Number	Description	Spec. Reference	Estimated Quantity ¹	Units	Unit Cost	Extended Cost
1	Site Preparation	02110	2.6	AC		
2	Excavation	02222	4,300	CY		
3	Over-Excavation & Backfill	02222, 02223	100	CY		
4	Aggregate Surfacing	02500	8,100	SY		
5	Asphalt Paving	02500	400	SY		
6	Asphalt Paving (Parking Area)	02500	200	SY		
7	Concrete Paving	03310	400	SY		
8	Infiltration Basin	02270	1	LS	LS	
9	Silt Fence	02270	1,300	LF		
10	Stone Filter Fence	02270	5	EA		
11	15" Diam. RCP (Class III) (Culverts C-1 & C-2)	02270	80	LF		
12	Water Line Installation	-----	710	LF		
13	Septic Sewage Line Installation	02617	30	LF		
14	Revegetation	02930	1	AC		
15	Vegetative Buffer	-----	750	LF		
16	Wood Fence	-----	1,500	LF		
17	Attendant Building Construction	Drawings G101-S201, P101	1	LS	LS	
18	Exterior Light Fixtures	Drawings E1.1-E2.1	15	EA		
19	Electrical (Outdoor)	Drawings E1.1-E2.1	1	LS	LS	
20	Permit Fees & Coordination	-----	1	LS	LS	

Pay Item Number	Description	Spec. Reference	Estimated Quantity ¹	Units	Unit Cost	Extended Cost
21	Surveying Control	-----	1	LS	LS	
22	Bonds, Mobilization & Insurance	-----	1	LS	LS	

The TOTAL BASE BID PRICE for the pay items listed above is as follows:

(In Words) _____ Dollars and _____ Cents.

(In Numbers) (\$ _____.)

Notes:

1. Engineer's estimated quantities are based on in-place quantities. Areas and lengths are based on horizontally projected areas and lengths. No adjustments have been made for stripping topsoil, slopes, uneven contours, compaction factors, etc.

NOTE: PROPOSAL SIGNATURE REQUIRED ON PAGE P-13. ALL PROPOSALS MUST BE PROPERLY EXECUTED TO BE CONSIDERED A VALID BID.

B. Alternate Bid Items (Parkton):

The above Base Bid may be adjusted by the following Alternate Bid amounts in any combination, should the Owner choose in their sole discretion:

Alt. Item Number	Description	Spec. Reference	Estimated Quantity ¹	Units	Unit Cost	Extended Cost
B1	Water Well Drilling	-----	-----	LF		
B2	Septic System Installation	02617	-----	LF		

Notes:

1. Engineer's estimated quantities are based on in-place quantities. Areas and lengths are based on horizontally projected areas and lengths. No adjustments have been made for stripping topsoil, slopes, uneven contours, compaction factors, etc.

NOTE: PROPOSAL SIGNATURE REQUIRED ON PAGE P-13. ALL PROPOSALS MUST BE PROPERLY EXECUTED TO BE CONSIDERED A VALID BID.

This page intentionally left blank.

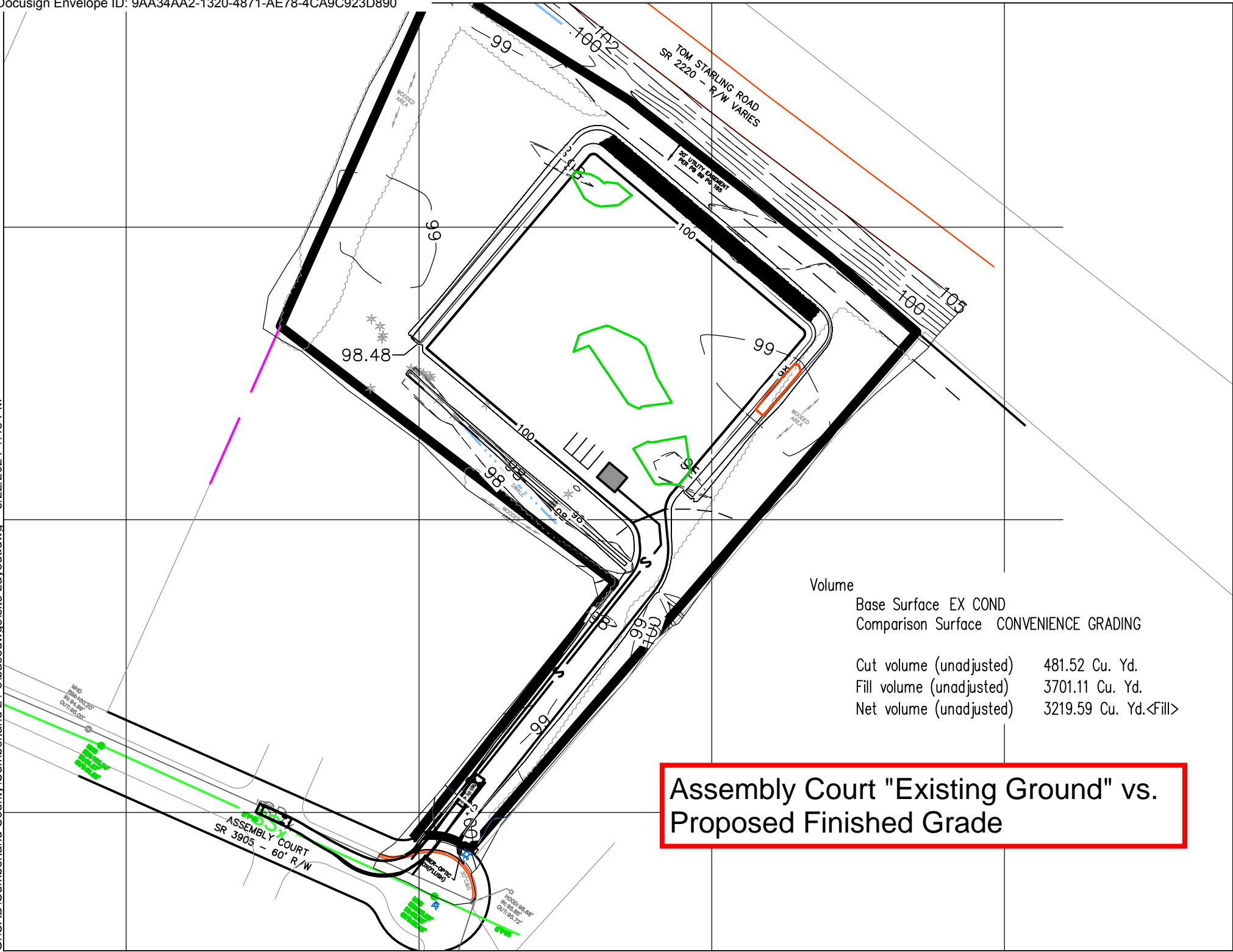

Assembly Court "Existing Ground" vs. Proposed Finished Grade

Parkton "Existing Ground" vs. Proposed Finished Grade

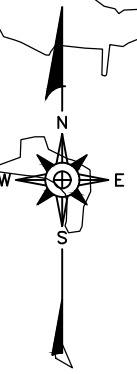

G:\CAD\Cumberland County\Camden 23-1\basedwgs\camden_convenience Site.dwg - 4/22/2025 9:06 AM

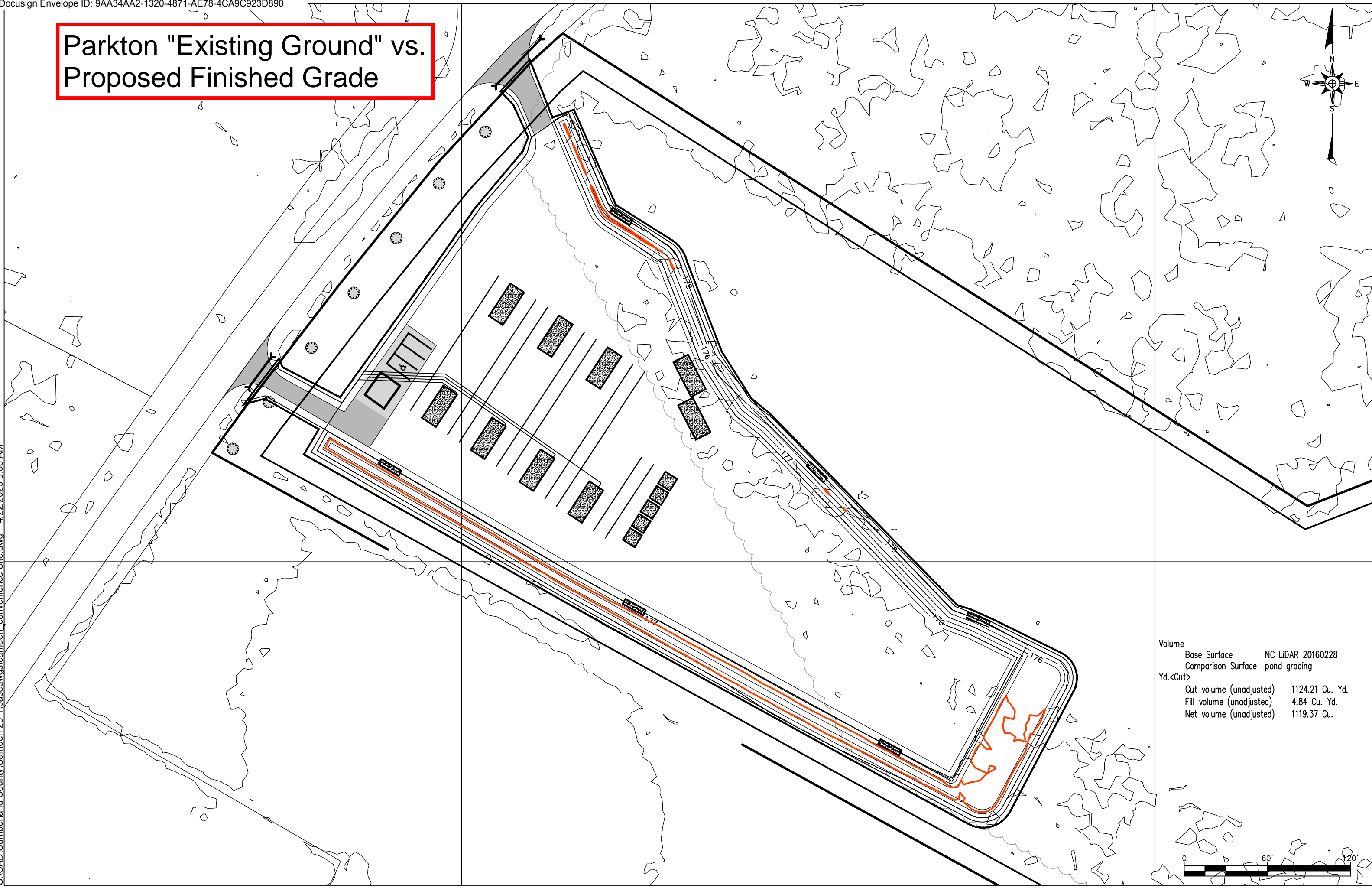

Volume	
Base Surface	NC LIDAR 20160228
Comparison Surface	pond grading
Yd.<Cut>	
Cut volume (unadjusted)	1124.21 Cu. Yd.
Fill volume (unadjusted)	4.84 Cu. Yd.
Net volume (unadjusted)	1119.37 Cu.

