



CUMBERLAND COUNTY

NORTH CAROLINA

ENGINEERING DEPARTMENT

Hope Mills Library – Roof Repairs

Cumberland County is currently seeking bids on roof repairs for the Hope Mills Public Library located at 3411 Golfview Rd. Hope Mills, NC 28348. Specifications are listed below. Bids shall be submitted to the following by 10:00 AM 12/05/2025; Sean Underwood, 130 Gillespie Street, Suite 214, Fayetteville, NC 28301 or sunderwood@cumberlandcountync.gov. Any questions shall be directed back to me via email by end of day 12/01/2025 so that I can provide each bidder with the same information.

The purpose of this project is to repair damaged roofing components. (see attached drawings/notes). Quality assurance is critical. All work must comply with local building and fire codes, OSHA safety regulations, and manufacturer installation instructions. The contractor shall provide any necessary permits, all materials, labor and equipment to complete the job. A final inspection will be conducted jointly by the contractor and a designated library representative to confirm completion and compliance. The contractor is responsible for daily cleanup of the worksite. All debris must be removed and disposed of in accordance with municipal regulations. Landscaping and public walkways must be protected throughout the project, and the site must be restored to a clean and safe condition upon completion.

Work is to be done during normal operating hours, and the schedule shall be discussed prior to any work starting. Contractor will ensure minimal disruption to library operations and full compliance with public safety and accessibility standards. Please keep in mind this is a public library. There should be no communication between crew members and patrons. The contractor will have 30 days to complete the project once a PO has been issued. Quotes will be due by **Friday, December 4, 2025, 10 AM EST.**

CONSULTANTS

PROJECT NAME

HOPE MILLS LIBRARY ROOF REPAIRS

FOR
CUMBERLAND COUNTY

3411 GOLFVIEW ROAD
HOPE MILLS, NORTH CAROLINA 28348

SEAL



BID SET

PROJECT TEAM

DESIGNED BY:
S. FLEMING
DRAWN BY:
K. HALE
CHECKED BY:
S. FLEMING

REVISIONS

NO.	DESCRIPTION	DATE

SHEET TITLE

ROOF PLAN, GENERAL NOTES AND DETAILS

ISSUE DATE

10/2/2025

PROJECT NO.

25-72

SHEET NUMBER

R1.0

1. ROOF AREAS A, B, C, D, E, F, G AND I: PROVIDE AND INSTALL COUNTERFLASHING AND SEALANT AT RAKE WALLS AS SHOWN ON DETAIL. 4R1.0 COUNTERFLASHING TO BE .040 INCH THICK ALUMINUM WITH 2 COAT PVDF COATING (AAMA 2605). COLOR MATCH TO EXISTING FLASHING. OVERLAP FLASHING SECTIONS 6" MIN.
2. ROOF AREA H (APPROX. 1950 SF): DEMO EXISTING SHINGLES, UNDERLAYMENT AND DAMAGED ROOF DECKING. PROVIDE AND INSTALL REPLACEMENT DECKING WHERE REQUIRED, ICE AND WATER SHIELD UNDERLAYMENT (GRACE VYCOR) AND SHINGLES (OWENS CORNING BERKSHIRE SHINGLES, SHERWOOD BEIGE OR APPROVED EQUAL) TO MATCH EXISTING ADJACENT ROOF AREAS.
3. PROVIDE 64 SF OF REPLACEMENT ROOF DECKING IN THE BASE BID IN ADDITION TO AREAS SHOWN ON 1/R1.0.
4. REPLACE ALL EXPOSED NAILS AT HEADWALL FLASHING WITH GASKET HEAD ROOFING SCREWS (SEE DETAIL 5/R1.0). SCREW HEAD TO MATCH COLOR OF EXISTING FLASHING. REMOVE AND REPLACE EXISTING SEALANT AT HEADWALL FLASHING JOINTS TYP.
5. SEALANT TO BE SIKAFLEX NP-1. COLOR MATCH TO FLASHING. CONTRACTOR TO CLEAN ROOF OF DIRT AND DEBRIS AS REQUIRED AT AREAS OF SEALANT WORK PRIOR TO APPLICATION.
6. DIMENSIONS FOR NEW SHEET METAL COMPONENTS ARE TO BE FIELD VERIFIED BEFORE FABRICATION.
7. FOLLOW RECOMMENDATIONS OF MEMBRANE MANUFACTURER, SPRI, NRCA, SMACNA, AND INDUSTRY STANDARDS UNLESS SHOWN OTHERWISE.
8. NOTICE TO ENGINEER: CONTRACTOR IS TO NOTIFY ENGINEER 48 HOURS PRIOR TO THE START OF DEMOLITION WORK AT ROOF AREA H.

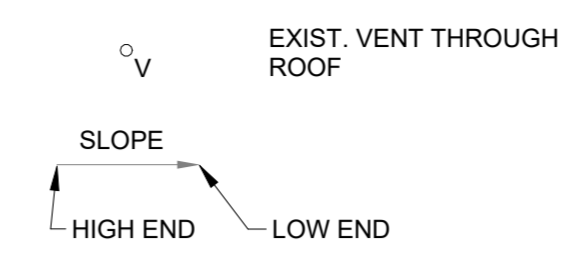

GENERAL NOTES - ROOFING 2
NOT TO SCALE R1.0

LEGEND - ROOF SYMBOLS 3
NOT TO SCALE R1.0

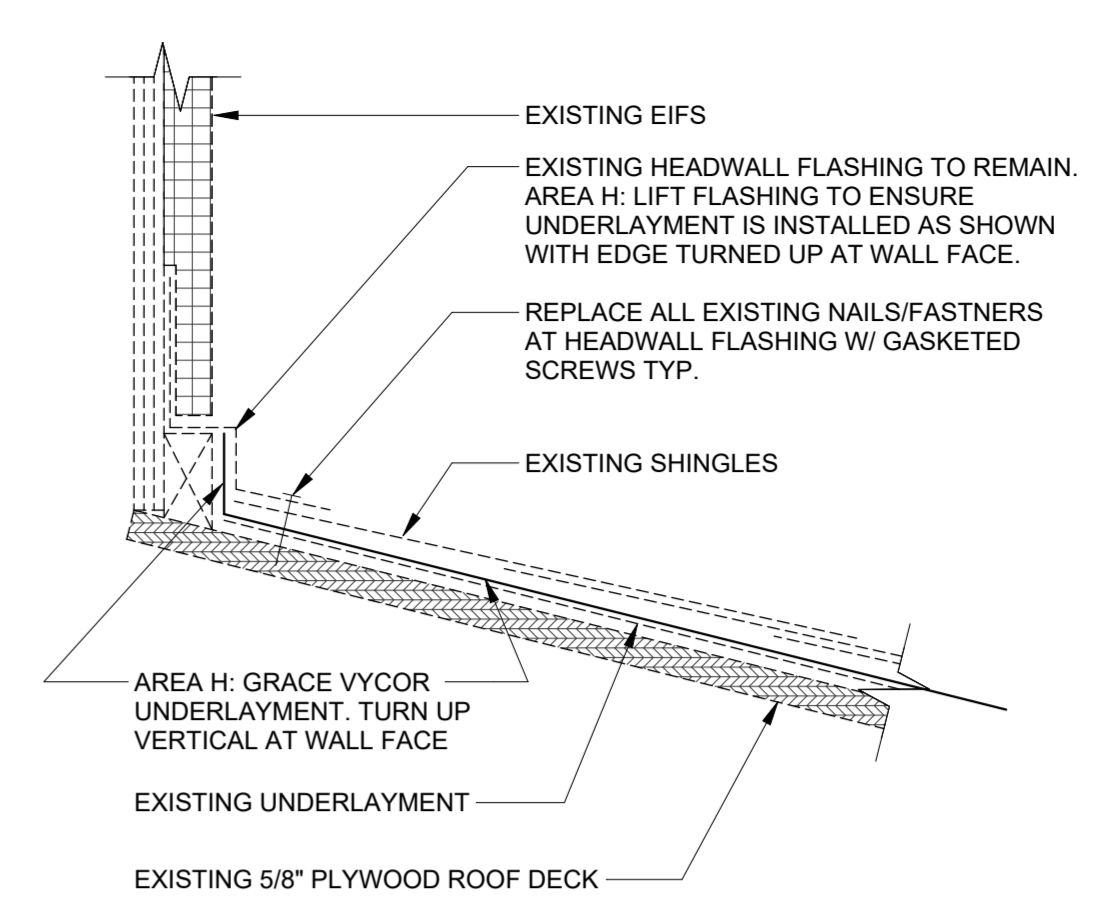

HEAD WALL FLASHING TYPICAL DETAIL 5
3" = 1'-0" R1.0

NOTE:
EXISTING TO REMAIN SHOWN DASHED TYP.

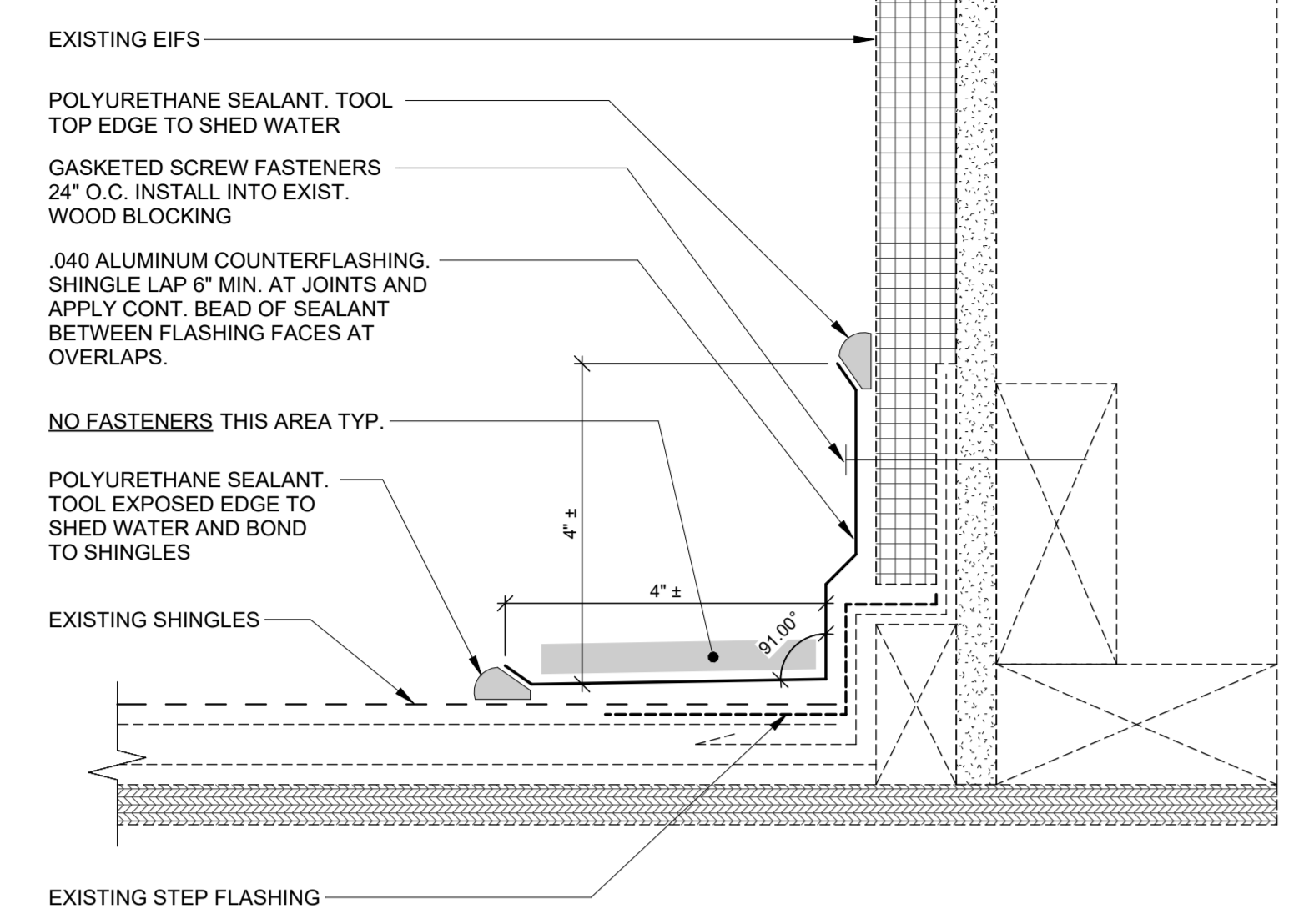

COUNTERFLASHING TYPICAL DETAIL 4
6" = 1'-0" R1.0

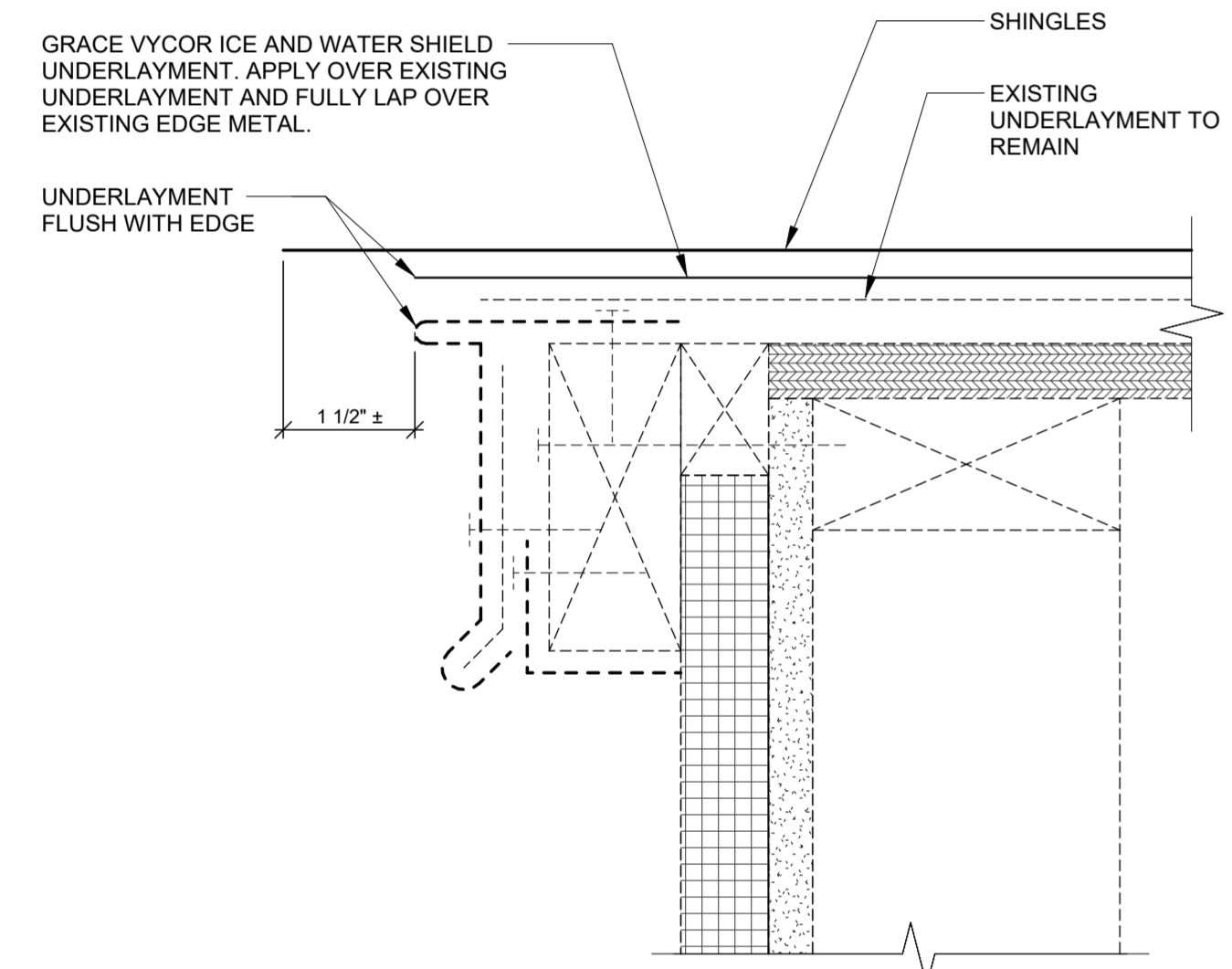

AREA H: TYPICAL ROOF EDGE DETAIL 6
6" = 1'-0" R1.0

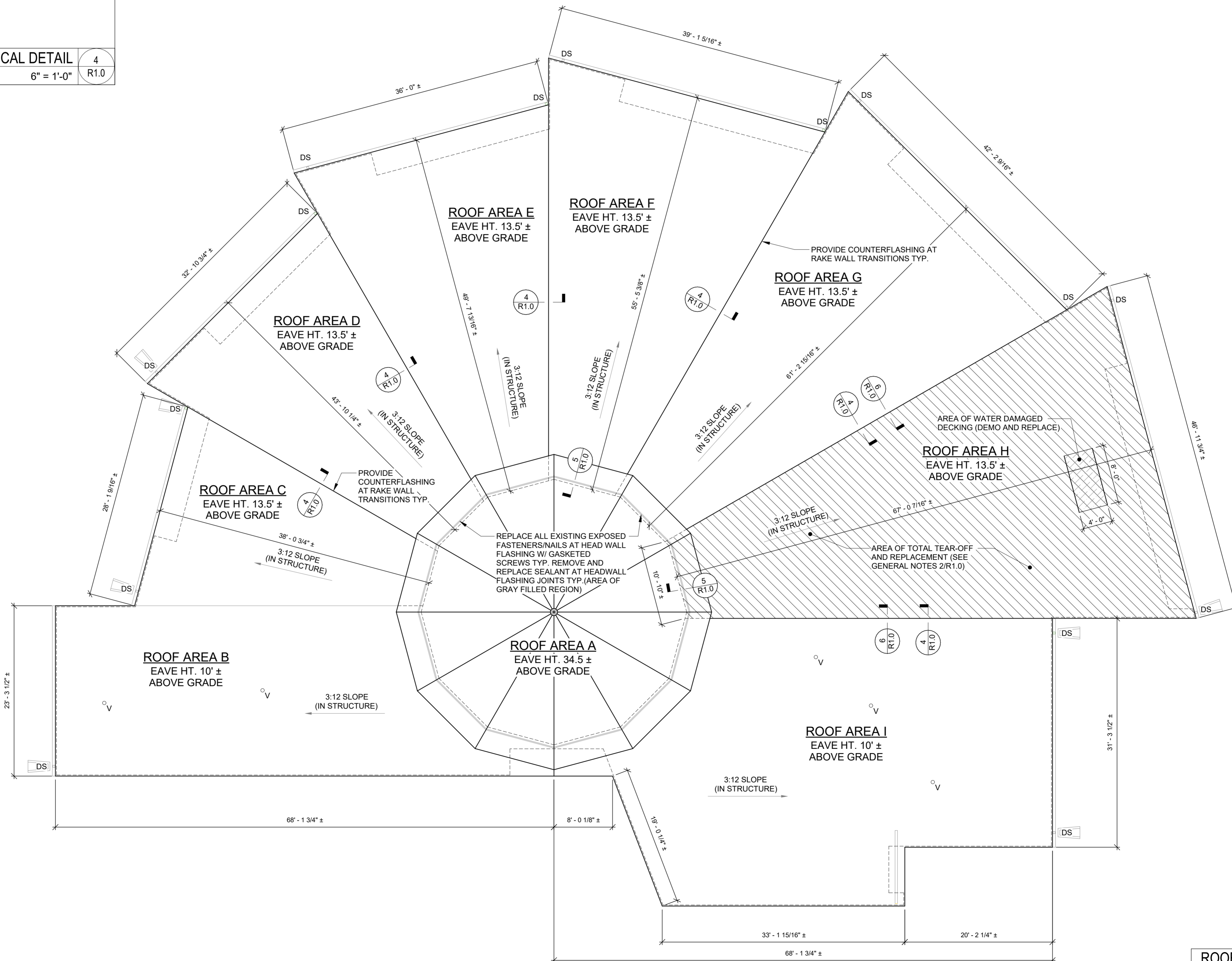

ROOF PLAN 1
1/8" = 1'-0" R1.0