



514 Market Street Wilmington, NC 28401
phone 910.762.2621
www.bmharch.com

November 22, 2024

ADDENDUM #4

North Carolina Aquariums
Jennette's Pier Decking Repair and Replacement
SCO ID# 22-25352-01A

This addendum forms a part of the contract documents and modifies the original drawings and project manual dated October 20, 2024. The enclosed additions, deletions, corrections, and changes shall be as binding as if incorporated in the original documents. All General Conditions, Special Conditions, etc. as originally specified shall apply to these items. Acknowledgement of receipt of this addendum will be required as part of the contract agreement.

- Item 1** **The bid time and location time will remain the same.** Sealed proposals will be received until 3:00 PM on **Thursday, December 5, 2024**, by James Mancari, Division Project Manager, North Carolina Aquariums, in the Oceanview Hall at Jennette's Pier, 7223 S. Virginia Dare Trail, Nags Head, NC 27956 at which time and place bids will be opened and publicly read.
- Item 2** **Drawings – Sheet A2.0** been revised and reissued (see **Attachment #1**).
- a. #1/A2.0 Enlarged Plan now shows 1-1/2" FRP grating at Beach Access stairs #1 & #2. Additional notes have been added at these stairs.
 - b. #1/A2.0 Enlarged Plan; notes regarding 2-1/2"x12" FRP planks at start of ramp has been changed to 3"x12" FRP planks.
 - c. #1/A2.0 Enlarged Plan; Location of delineation line between wood framing and concrete has been moved to correct location.
 - d. Plan #2/A2.0 Enlarged Bath House Decking; Decking material has changed to 1-1/2" FRP grating. FRP decking shall be used on deck, stairs and ramps. (stairs not hatched for clarity.)
 - e. #3/A2.0 Step Detail; Treads and Risers have been changed to 1-1/2" FRP grating. In addition, P.T. wood framing shall be provided on stairs and landing to raise FRP grating to meet top of new FRP decking.
 - f. Decking LEGEND has been revised to include the 1-1/2" FRP grating.
- Item 3** **Drawings – Sheet A2.1 and A2.2:** Triangular deck areas supported by wood framing as noted will receive same 3"x12" FRP deck planks as provided in surrounding areas. Disregard notes and legends indicating the use of 2-1/2"x12" FRP planks in these areas. The top of existing wood joists and timber support framing shall be trimmed in place approximately 1/2" to align with top of new FRP ledgers.

- Item 4 Drawings – Sheet A3.0** has been revised and reissued (see **Attachment #2**).
- #1/A3.0 Typical Pier Section: Detail tags have been updated to reference details on sheet A3.2. Size of continuous FRP support has been changed from 3x3 to 3-1/2"x3.
 - #3/A3.0 Enlarged Pier Plan: Detail tags have been updated to reference details on sheet A3.2.
 - #5/A3.0 Custom FRP Deck Plank - 2 1/2" Profile has been omitted.
 - #7/A3.0 Custom FRP Decking has been changed to 1-1/2" FRP Grating Profile.
 - #7/A3.0: Duplicated number; Donor Plaque detail number changed to #8.
 - #6/A3.0: Note added to "PLAN VIEW A" to reference detail #8/A3.0 .
- Item 5 Drawings – Sheet A3.1** has been revised and reissued (see **Attachment #3**).
- #1/A3.1: Details tags have been updated.
 - #2/A3.1 and #3/A3.1 FRP Decking Attachment details have been combined to show only the FRP ledger anchoring types. Revised detail number is #2/A3.1.
 - #7/A3.1 Enlarged FRP Anchoring Details: This new detail contains 2 section views that include modifying existing wood framing to receive new 3"x12" FRP deck planks. The top of existing wood joists and timber support framing shall be trimmed in place approximately 1/2" to align with top of new FRP ledgers.
- Item 6 Drawings – Sheet A3.2** has been revised and reissued (see **Attachment #4**).
- Details #5/A3.2 and #6/A3.2 were issued as bulletin drawings in Addendum #2. These details have been revised to show 1-1/2" FRP Grating in lieu of the 1-1/2"x12" FRP deck planks.
 - #7/A3.2 Enlarged FRP Fastening Details: These new enlarged details show each bearing point assembly, in order, across Typical Pier Section #1/A3.0. The intent is to show how the FRP decking needs to meet flush with top of concrete beams at perimeter guardrails.
- Item 8 Base Bid and possible Alternates**
- The Owner has stated that only the Base Bid and Alternates #4 and #5 will be considered for this phase of the Project. Alternates #1, #2, and #3 are not required to be part of the Bid proposal.
- Item 9 General Items**
- Construction phasing required to provide continuous egress to Pier House; one ramp to remain open while the other is being renovated. Provide temporary barricade/fencing and gates as necessary to prevent entry into the area of work. Coordinate final locations with owner. See Bulletin Drawing #B005. (See **Attachment #5**)
 - Shop drawings of the specified products installation intent will be provided by the contractor as specified in Section 013300 Submittal Procedures and 066500 FRP Fabrications.
 - There will be some sand removal necessary to install the decking in some locations. The contractor is responsible for removing the sand needed for demolition and installation. The sand can be pushed east to be out of the way of the work area.
 - Town of Nags Head statutes prohibit a manned boat within 600 feet of the pier.

- e. H-5 structural loading requirements do not apply to the Bath House decking and the two pier stairs to grade. See structural drawings for loading criteria at the Bath House.
- f. The bath house decking and pier decking will be the same color; Fibergrate "beige".
- g. Bath House decking has been changed to 1-1/2" FRP grating; Fibergrate Micro-Mesh 3/4" SQ top and 1-1/2" SQ bottom with slip resistant finish. This grating will also be used at the two stairs to grade located on the Pier entry ramps.
- h. The 2-1/2" FRP plank thickness has been omitted. The 3"x12" FRP planks will be used at all locations on the Pier except for the two stairs to grade that will have the 1-1/2" thick grating.

Prepared by:

George C. Hemingway III (Chip), AIA, LEED-AP
Bowman Murray Hemingway Architects

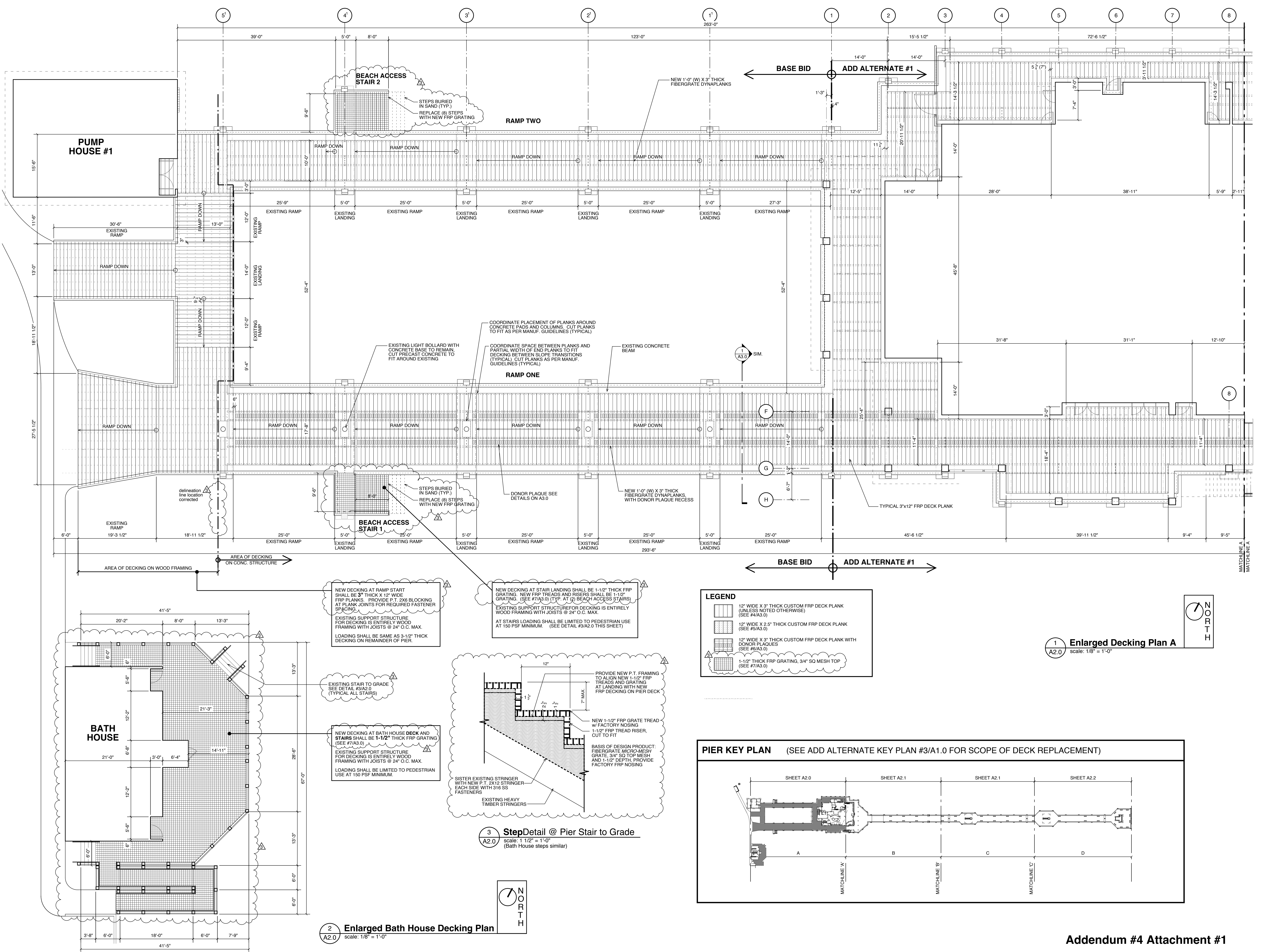

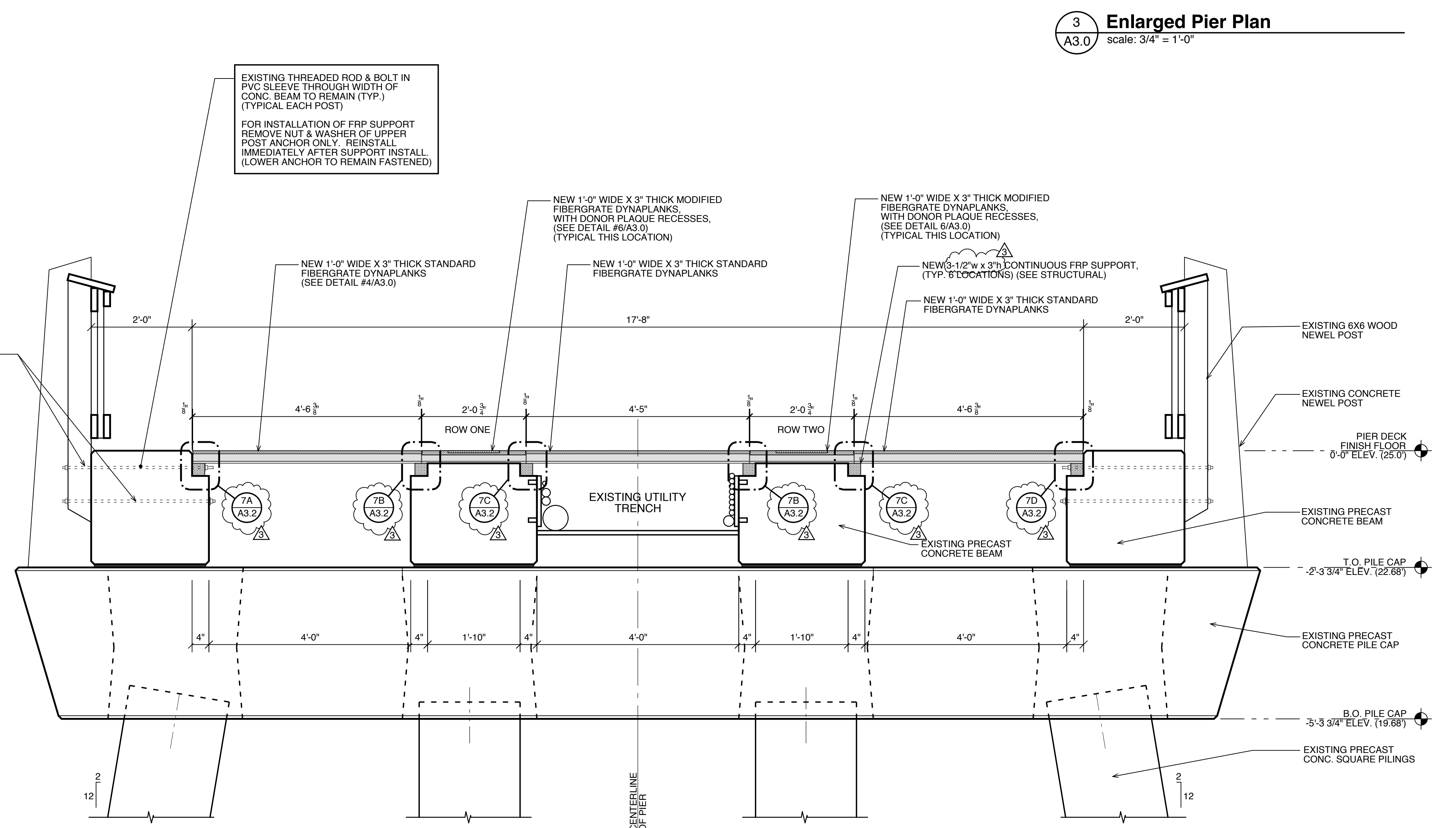
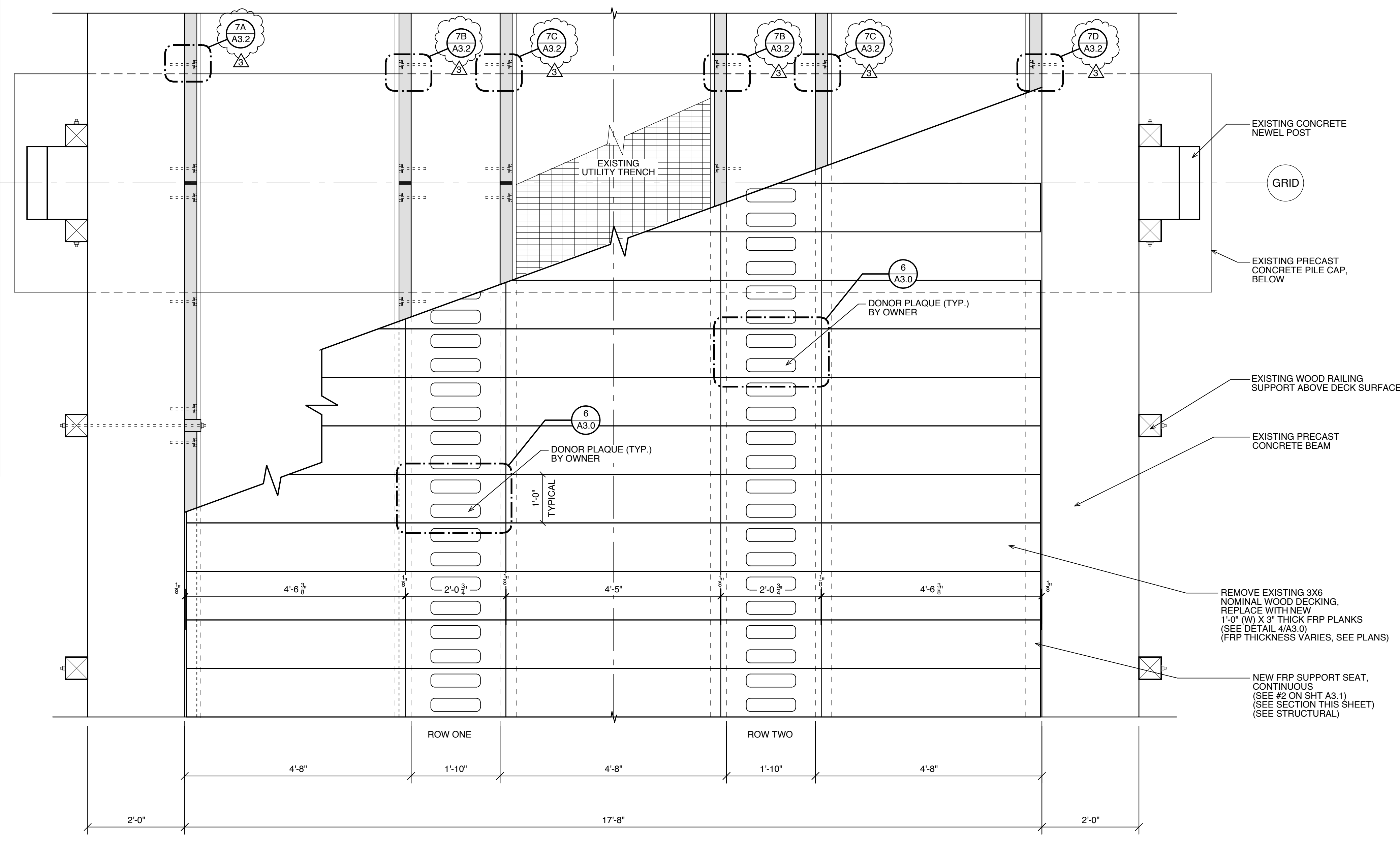
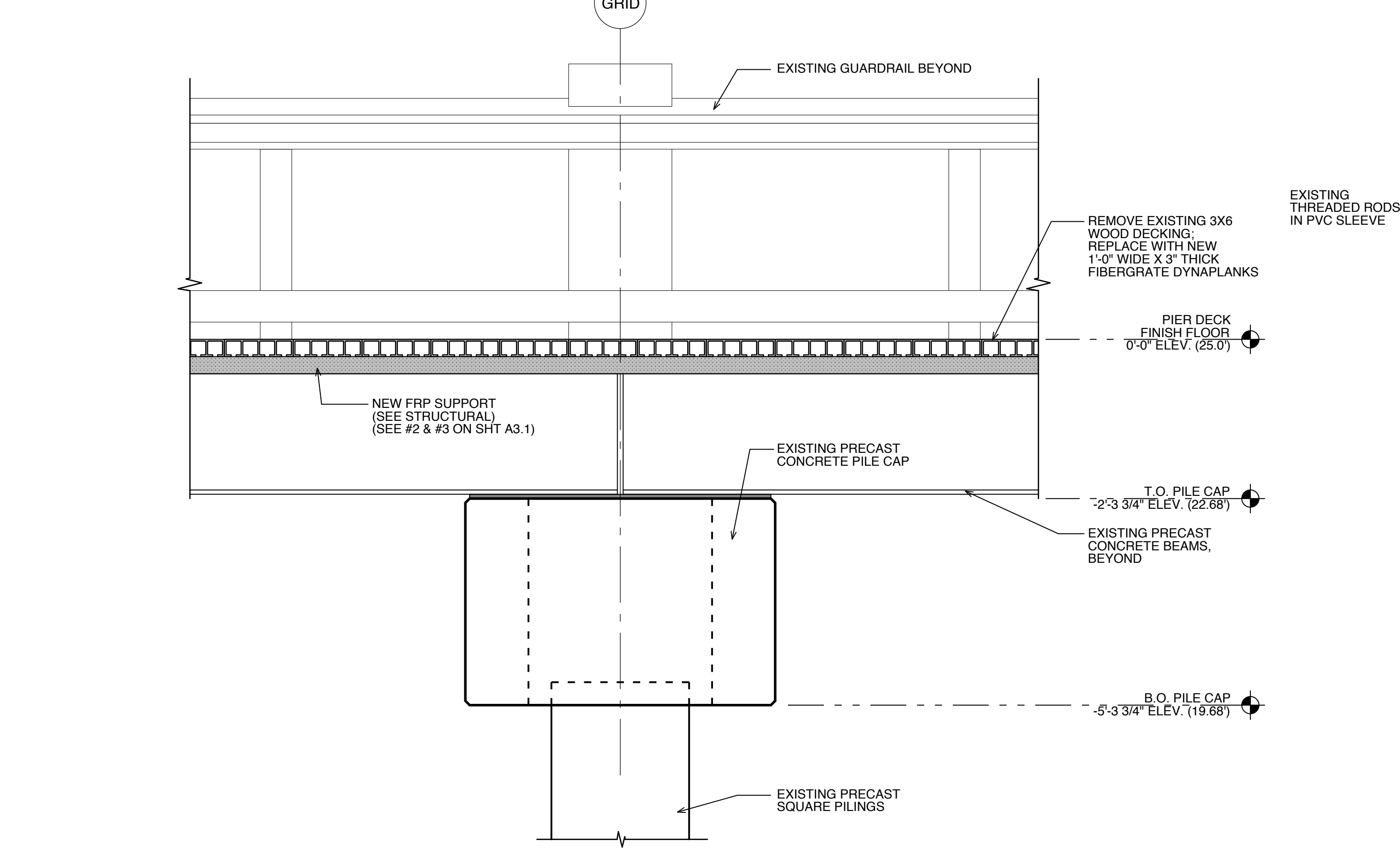
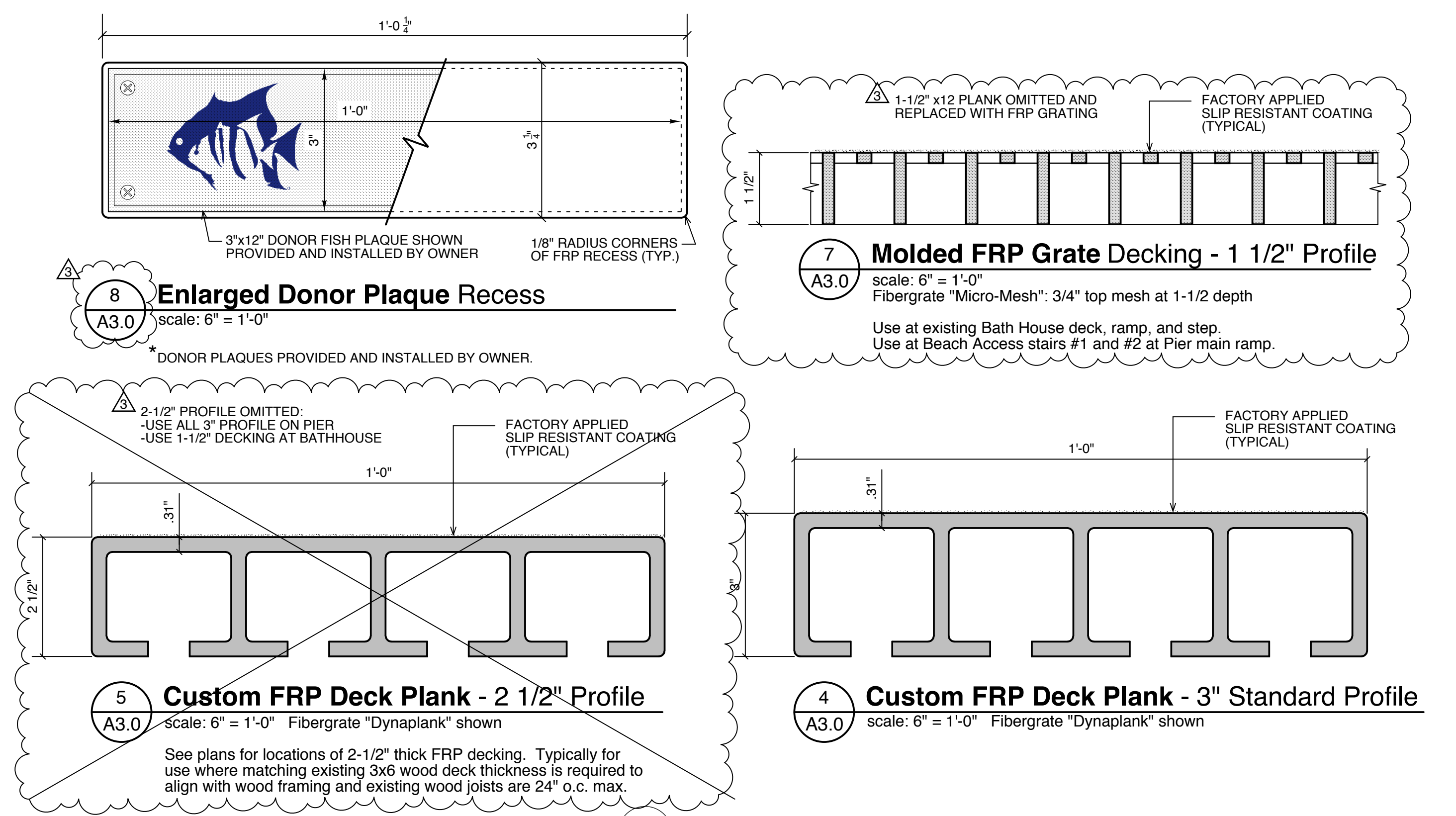
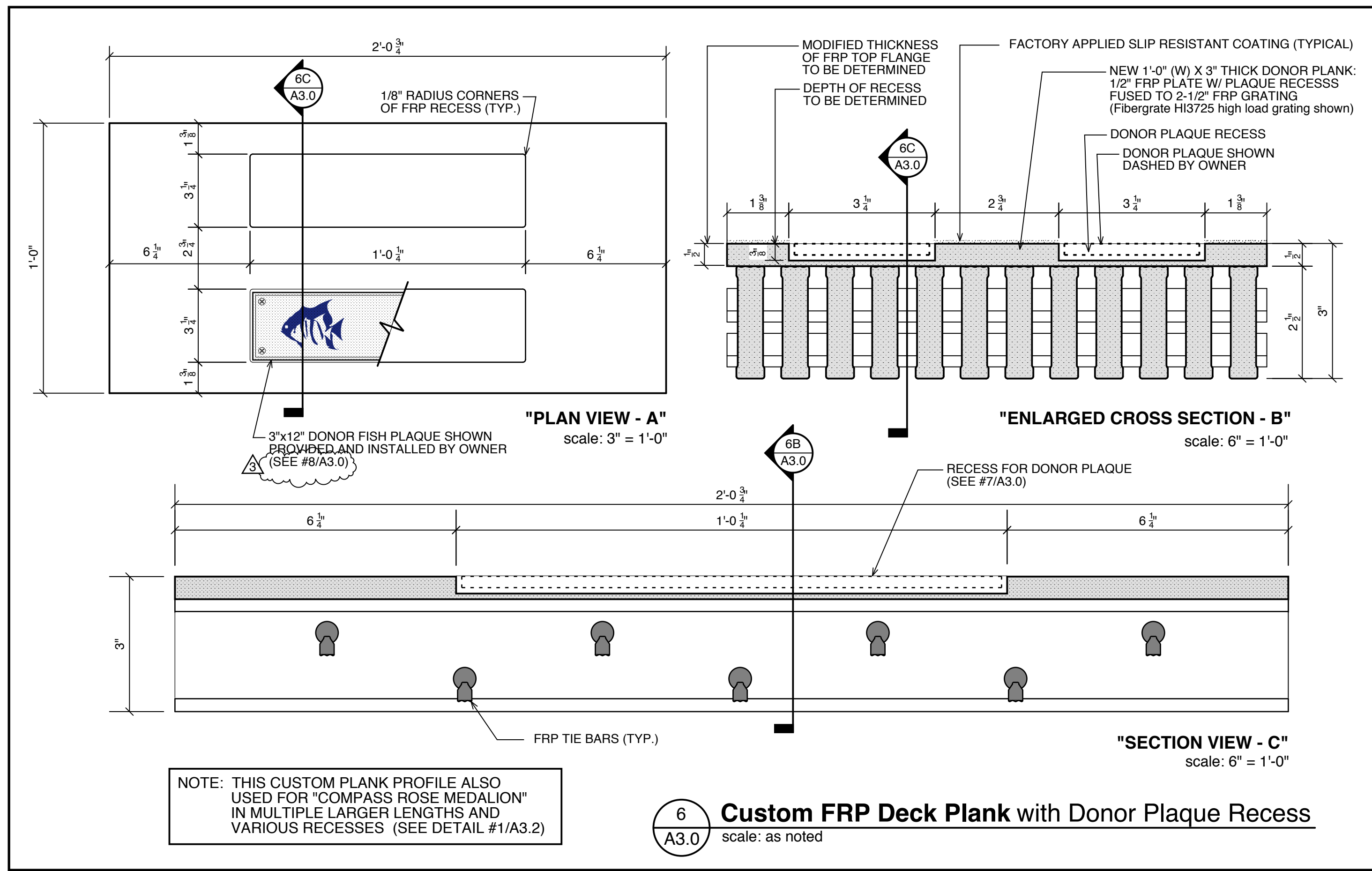

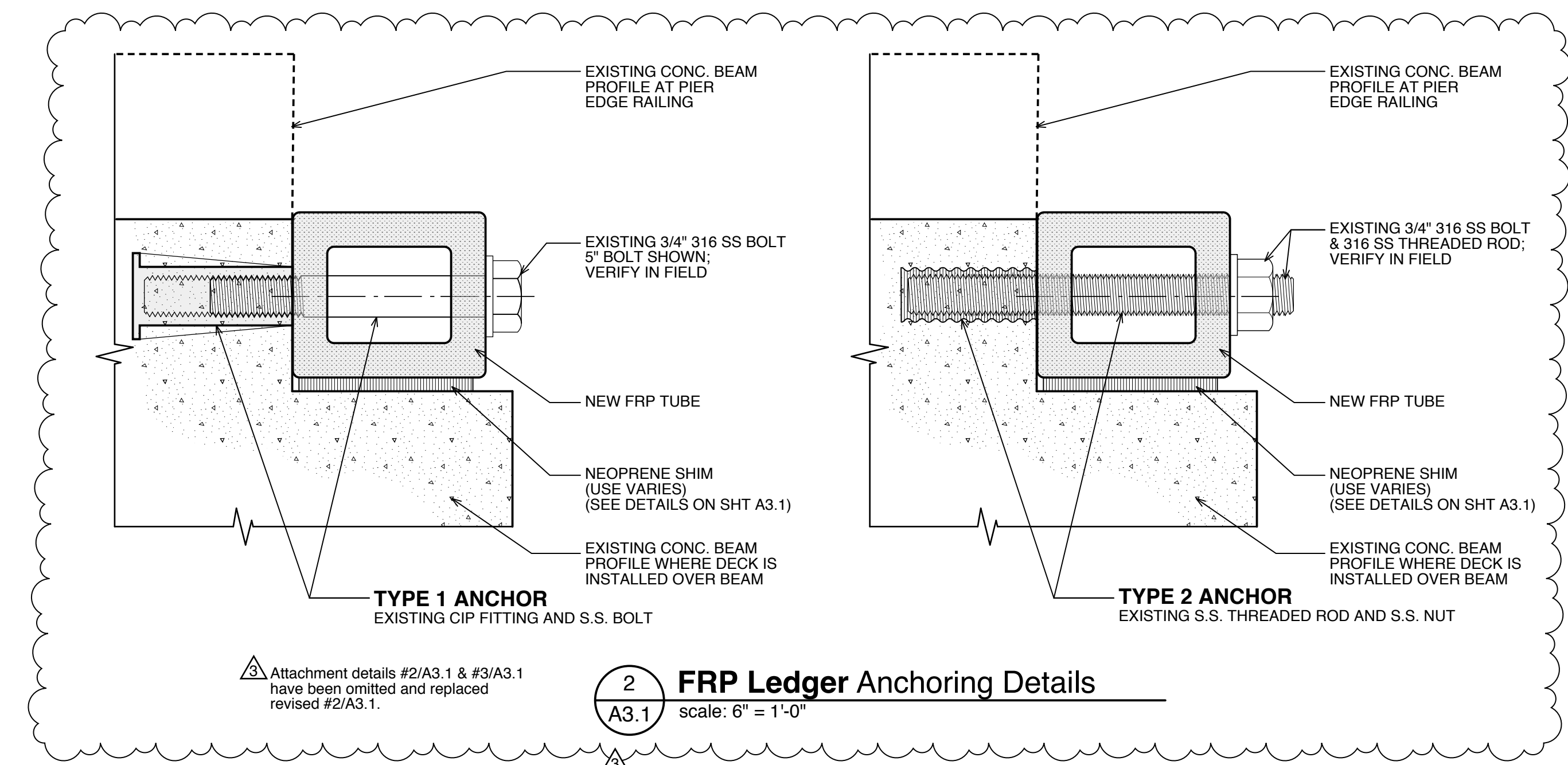
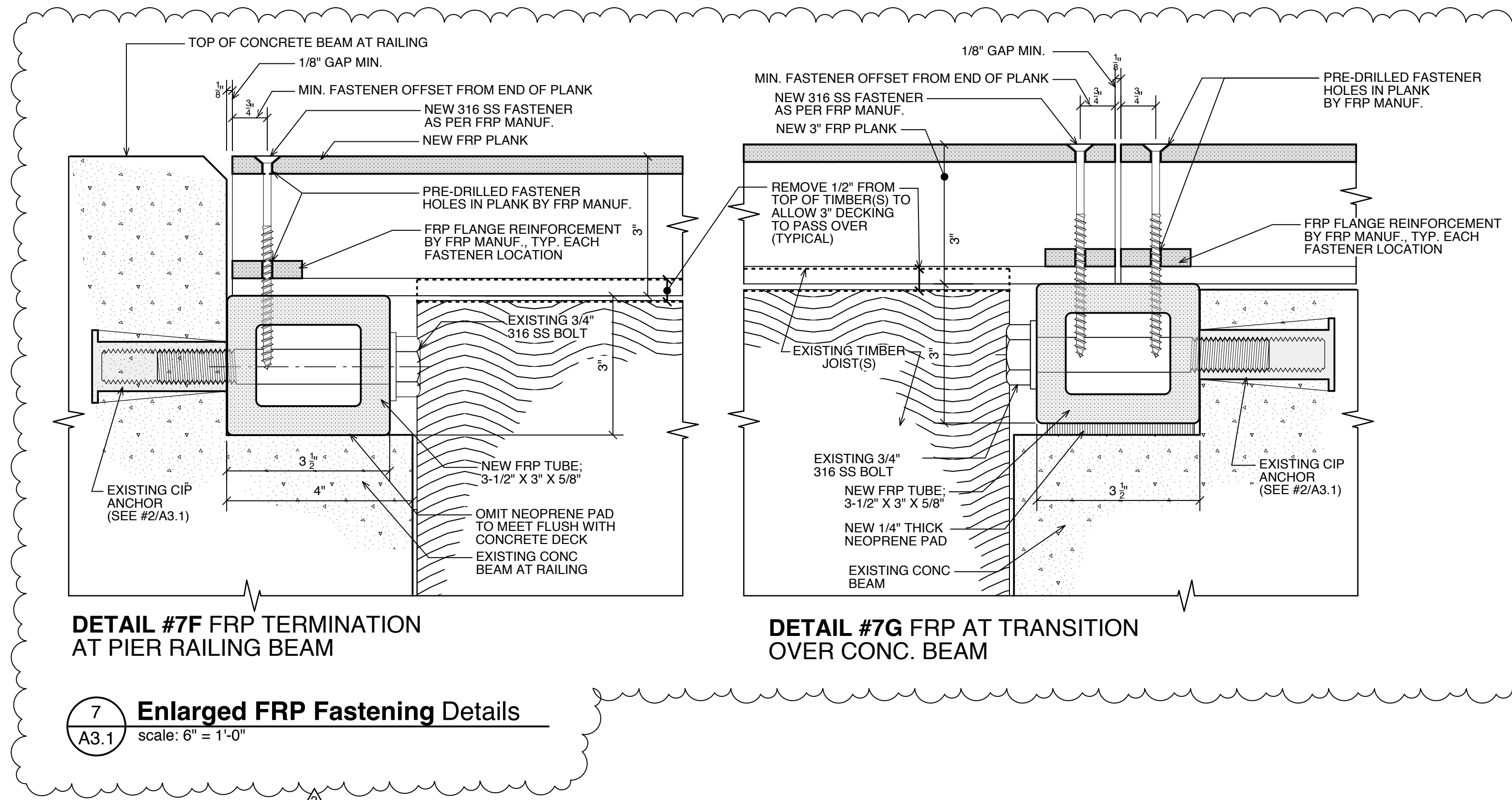

EXISTING THREADED ROD & BOLT IN PVC SLEEVE THROUGH WIDTH OF CONC. BEAM TO REMAIN (TYP.) (TYPICAL EACH POST)

FOR INSTALLATION OF FRP SUPPORT REMOVE NUT & WASHER OF UPPER POST ANCHOR ONLY. REINSTALL IMMEDIATELY AFTER SUPPORT INSTALL (LOWER ANCHOR TO REMAIN FASTENED)

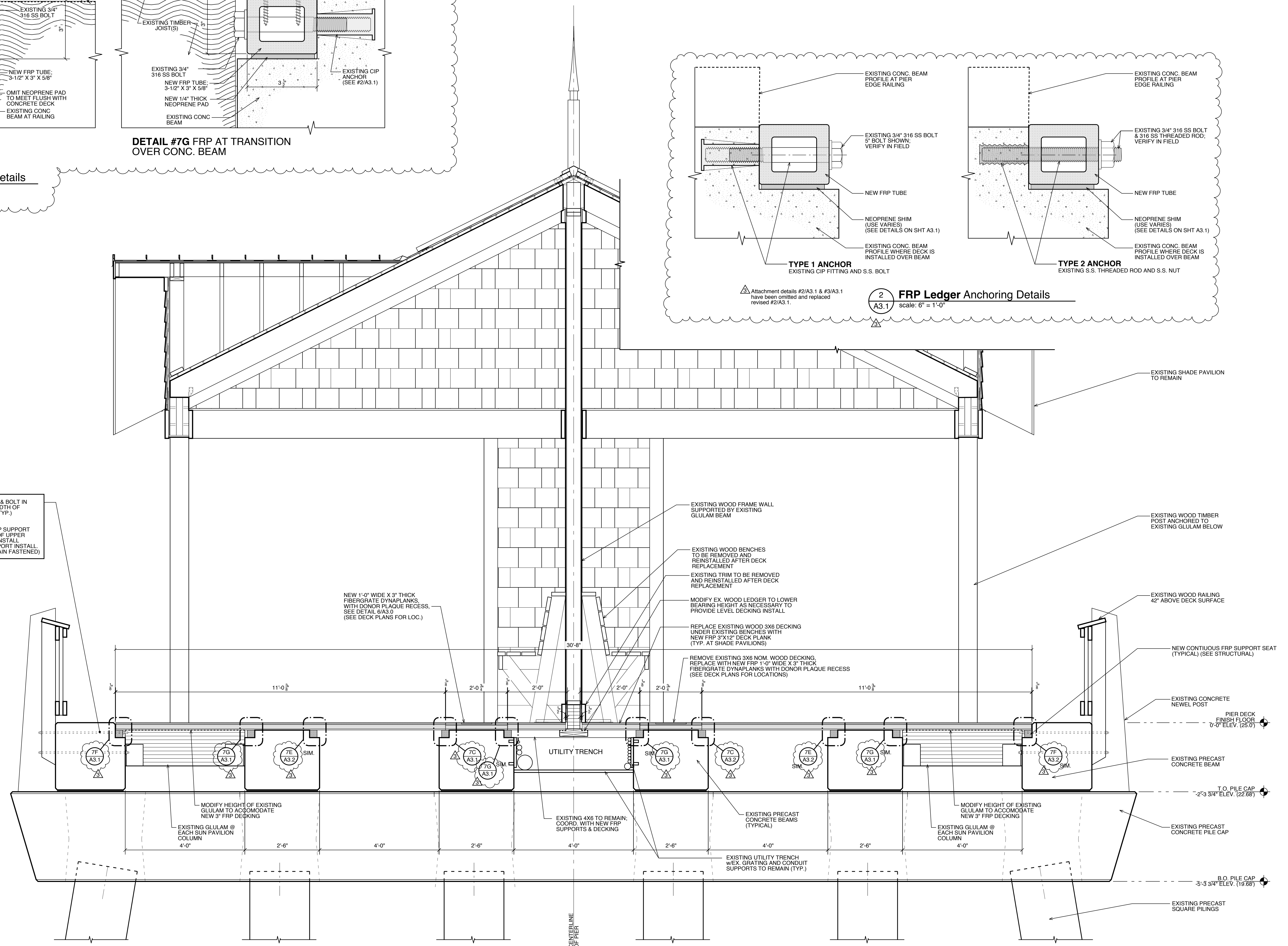

ATTACHMENT #5

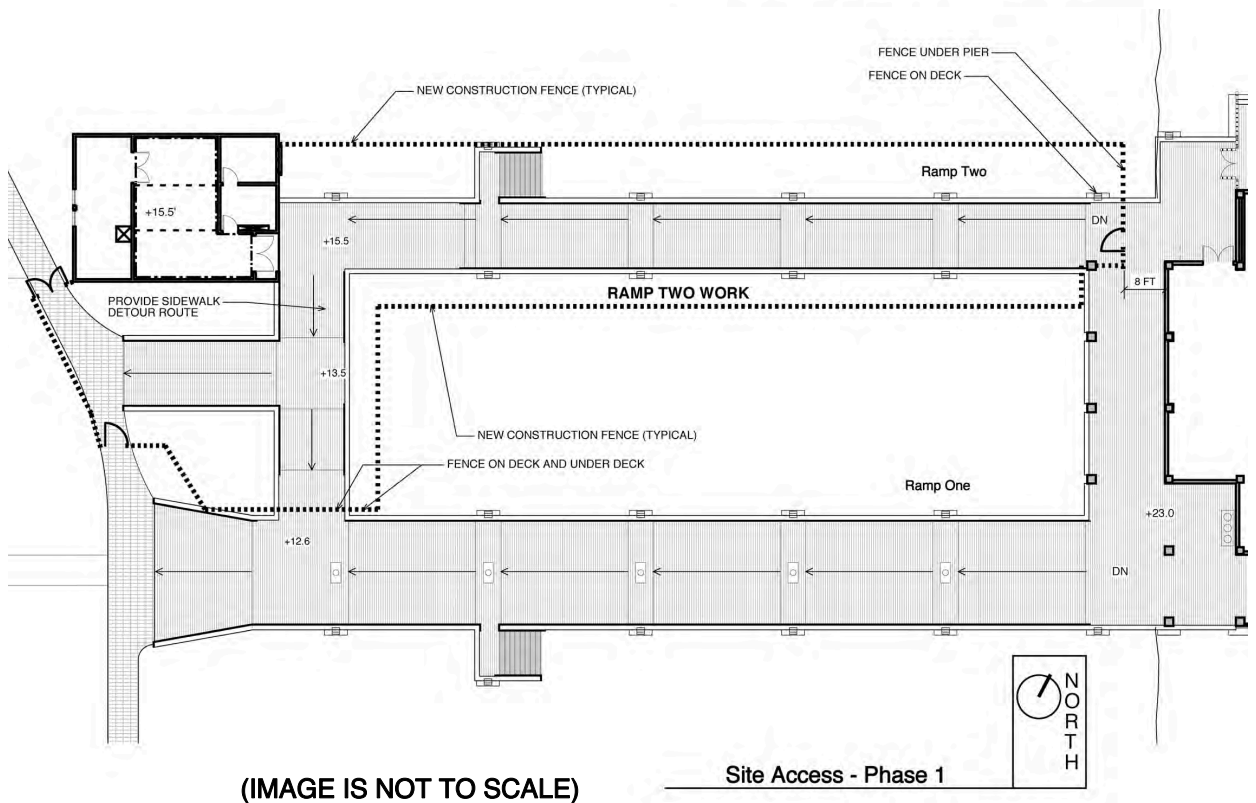
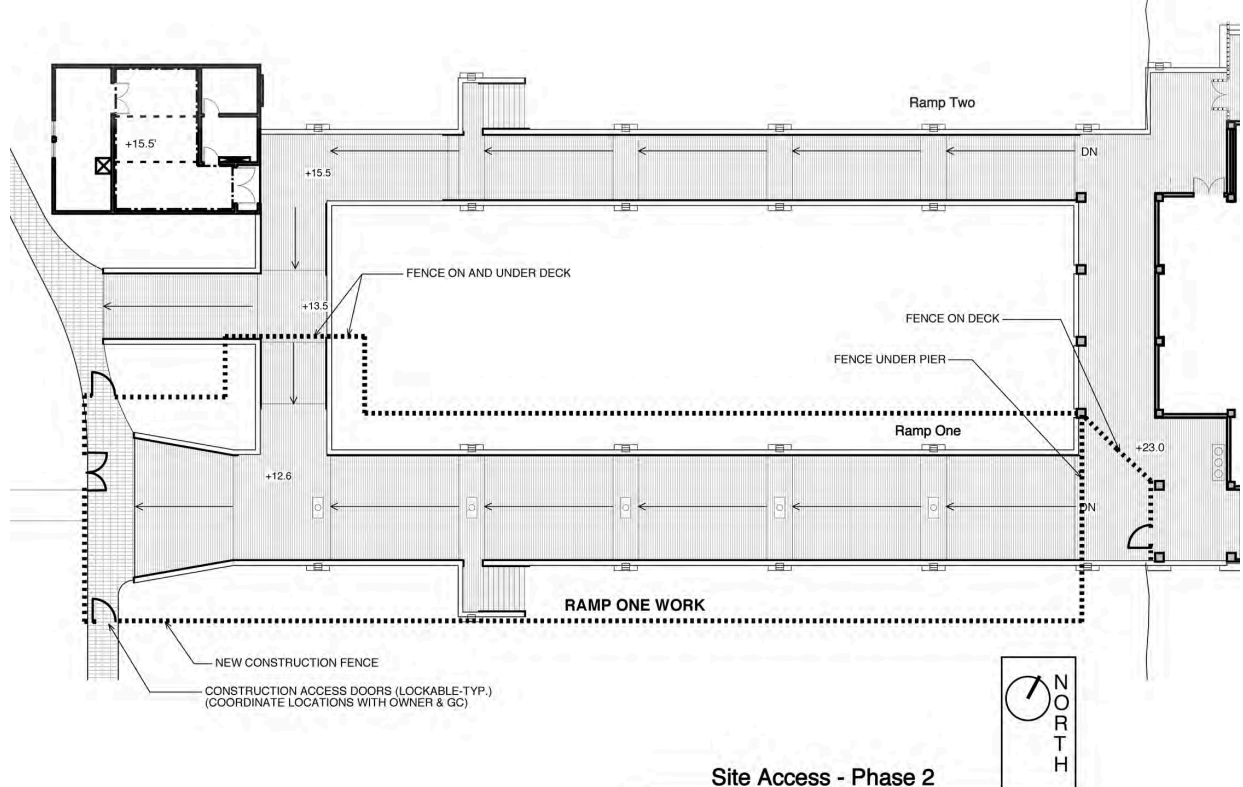

(IMAGE IS NOT TO SCALE)



514 Market Street
Wilmington, NC 28401
Tel - (910) 762-2621
www.bmharch.com

Addendum #04
North Carolina Aquariums
Jennette's Pier
Decking Repair / Replacement
Nags head, North Carolina

SCO #22-25352-01A

BULLETIN/SHEET #:	BD-005
SHEET REF.:	N/A
DATE:	11.21.24
CHECKED BY:	GCW
DRAWN BY:	AJT