

PROJECT: BERMUDA RUN RESURFACING

STATE OF NORTH CAROLINA
TOWN OF BERMUDA RUN

STATE	PROJECT REFERENCE	SHEET NO.	TOTAL SHEETS
N.C.	BERMUDA RUN RESURFACING	1	9

DAVIE COUNTY

LOCATION: GLEN ARBOR DR, OLD TOWNE DR, BERMUDA VILLAGE DR, JUNIPER CIRCLE, RIVERBEND DR, BRIDGE ST, ORCHARD PARK DR

TYPE OF WORK: RESURFACING, MILLING, & ASPHALT TREATMENT

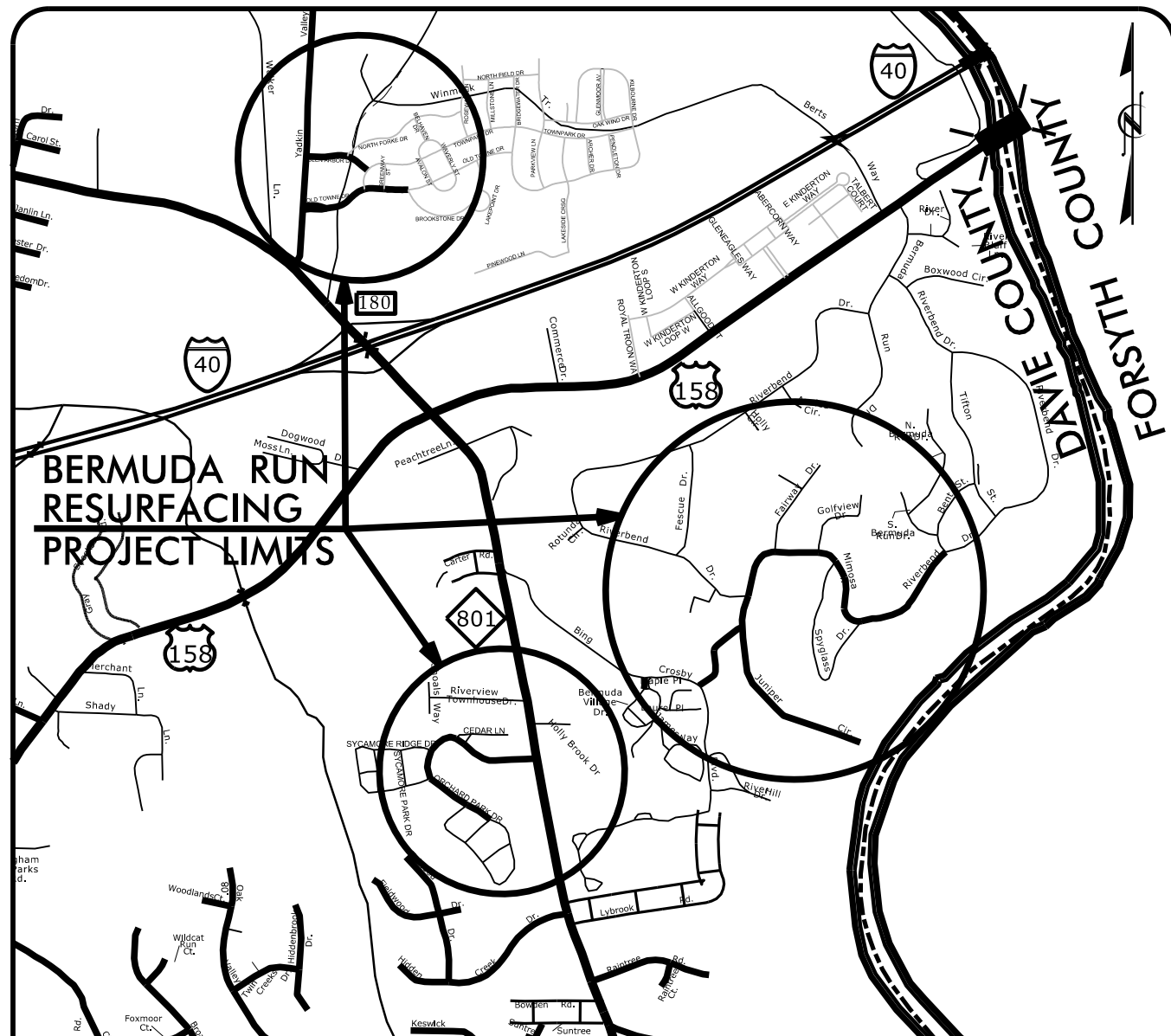

VICINITY MAP

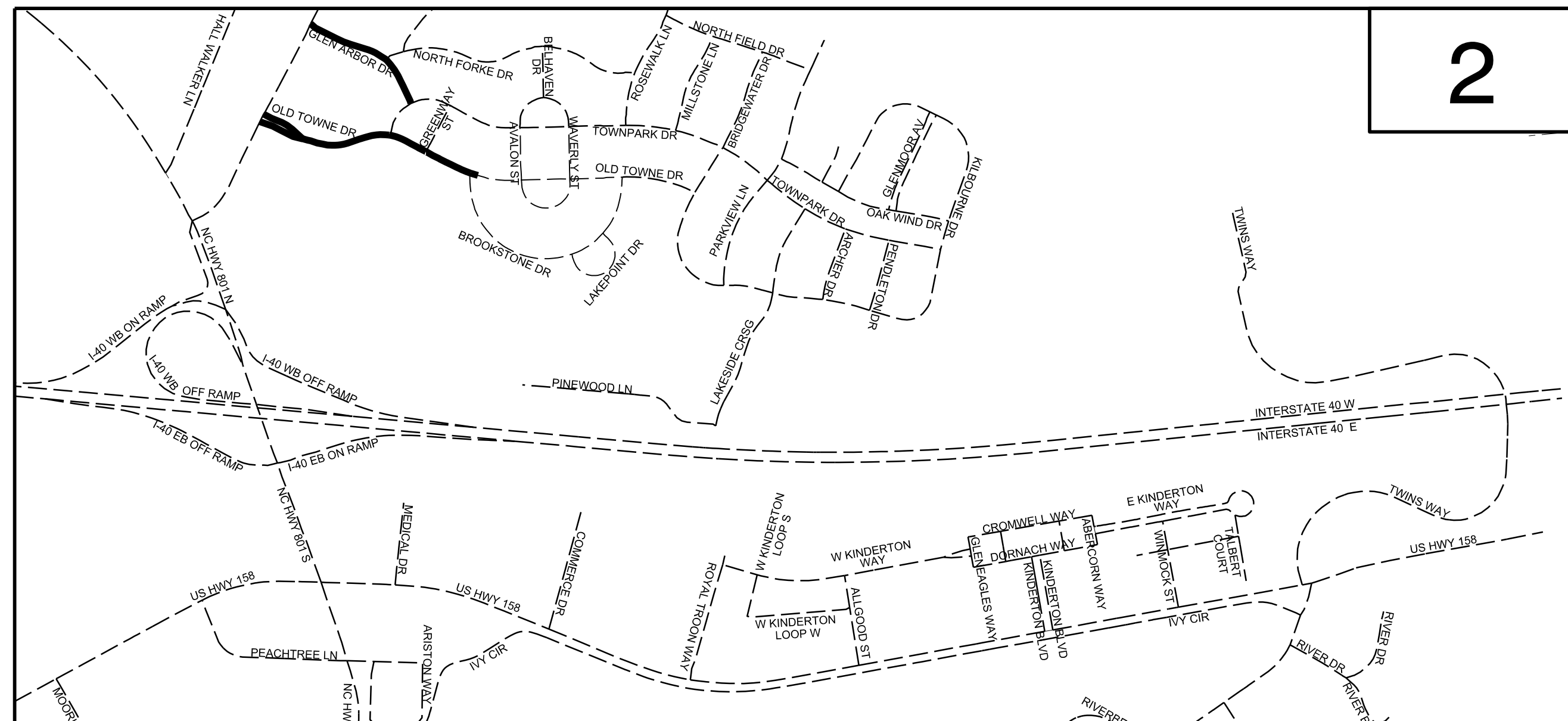

2

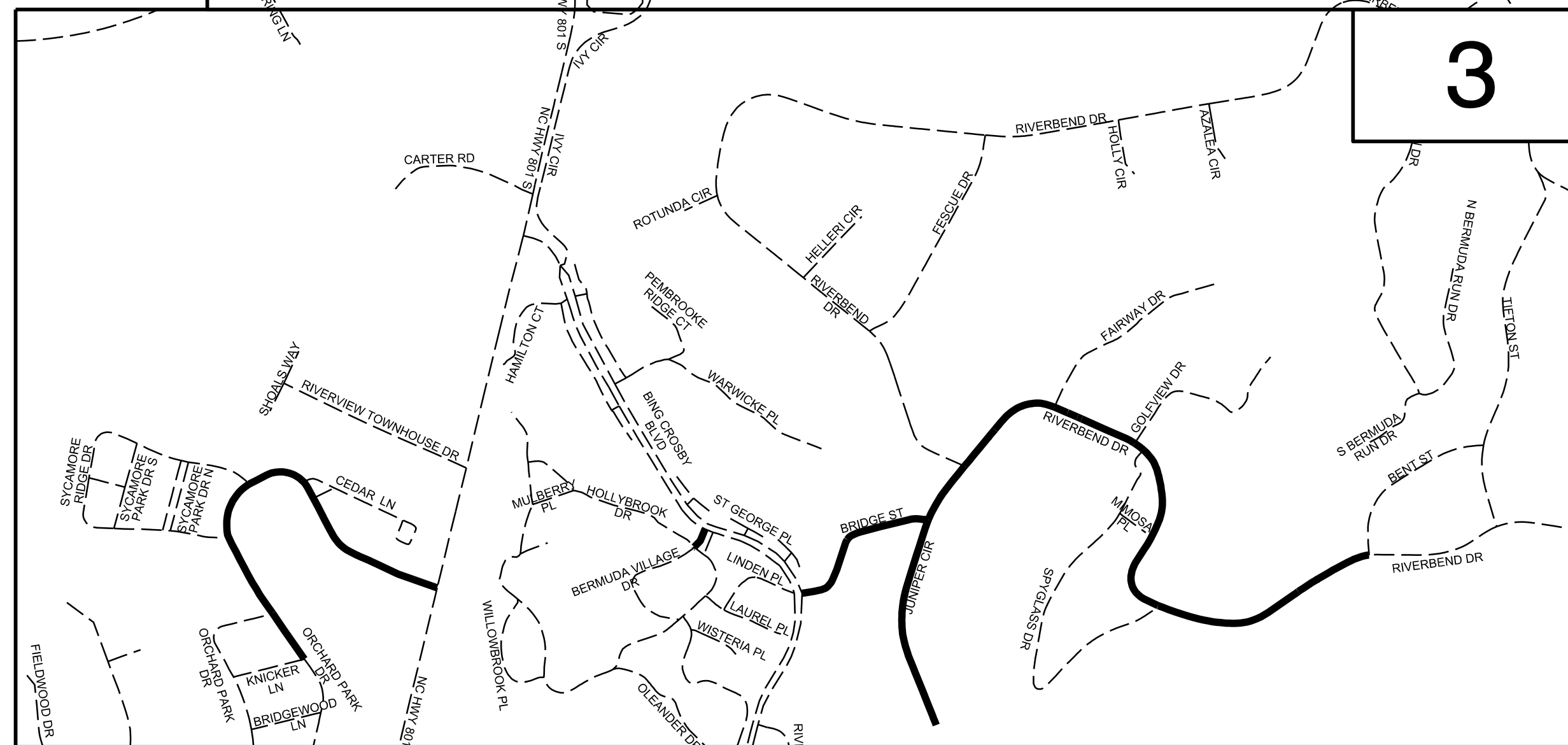

3

INDEX OF SHEETS

SHEET NO.	DESCRIPTION
1	TITLE SHEET
2 - 3	RESURFACING MAPS
4 - 6	TYPICAL SECTIONS
7 - 8	SUMMARY OF QUANTITIES
TMP-1	SIGNING DETAILS

DOCUMENT NOT CONSIDERED FINAL
UNLESS ALL SIGNATURES COMPLETED

NOT TO SCALE

TOWN OF BERMUDA RUN CONTACT:

ANDREW MEADWELL
TOWN MANAGER
336-998-0906

PROJECT LENGTH

MAP 1 - GLEN ARBOR DRIVE	= 0.08 MILES	MAP 8 - RIVERBEND DRIVE	= 0.66 MILES
MAP 2 - GLEN ARBOR DRIVE	= 0.06 MILES	MAP 9 - BRIDGE STREET	= 0.16 MILES
MAP 3 - OLD TOWNE DRIVE	= 0.14 MILES	MAP 10 - ORCHARD PARK DRIVE	= 0.46 MILES
MAP 4 - OLD TOWNE DRIVE	= 0.13 MILES		
MAP 5 - BERMUDA VILLAGE DRIVE	= 0.05 MILES		
MAP 6 - JUNIPER CIRCLE	= 0.22 MILES		
MAP 7 - JUNIPER CIRCLE	= 0.09 MILES		

TOTAL LENGTH - BERMUDA RUN RESURFACING = 2.05 MILES

Prepared For:

TOWN OF BERMUDA RUN
120 KINDERTON BLVD #100, BERMUDA RUN, NC

2024 STANDARD SPECIFICATIONS
7/7/2025

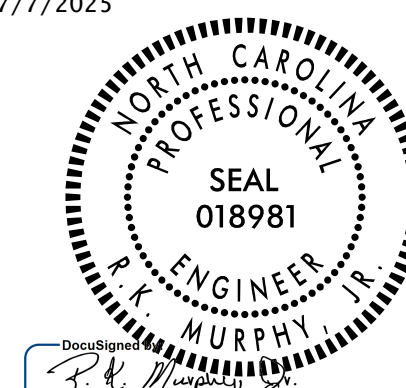

R.K. MURPHY, JR., PE
ROADWAY DESIGN ENGINEER

SCOTT L. KENNEDY
PROJECT DESIGN ENGINEER



REVISIONS
 8/17/99

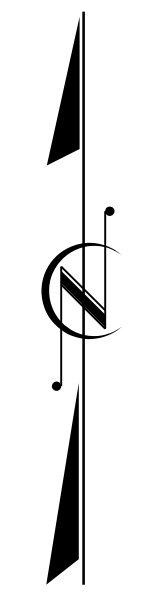
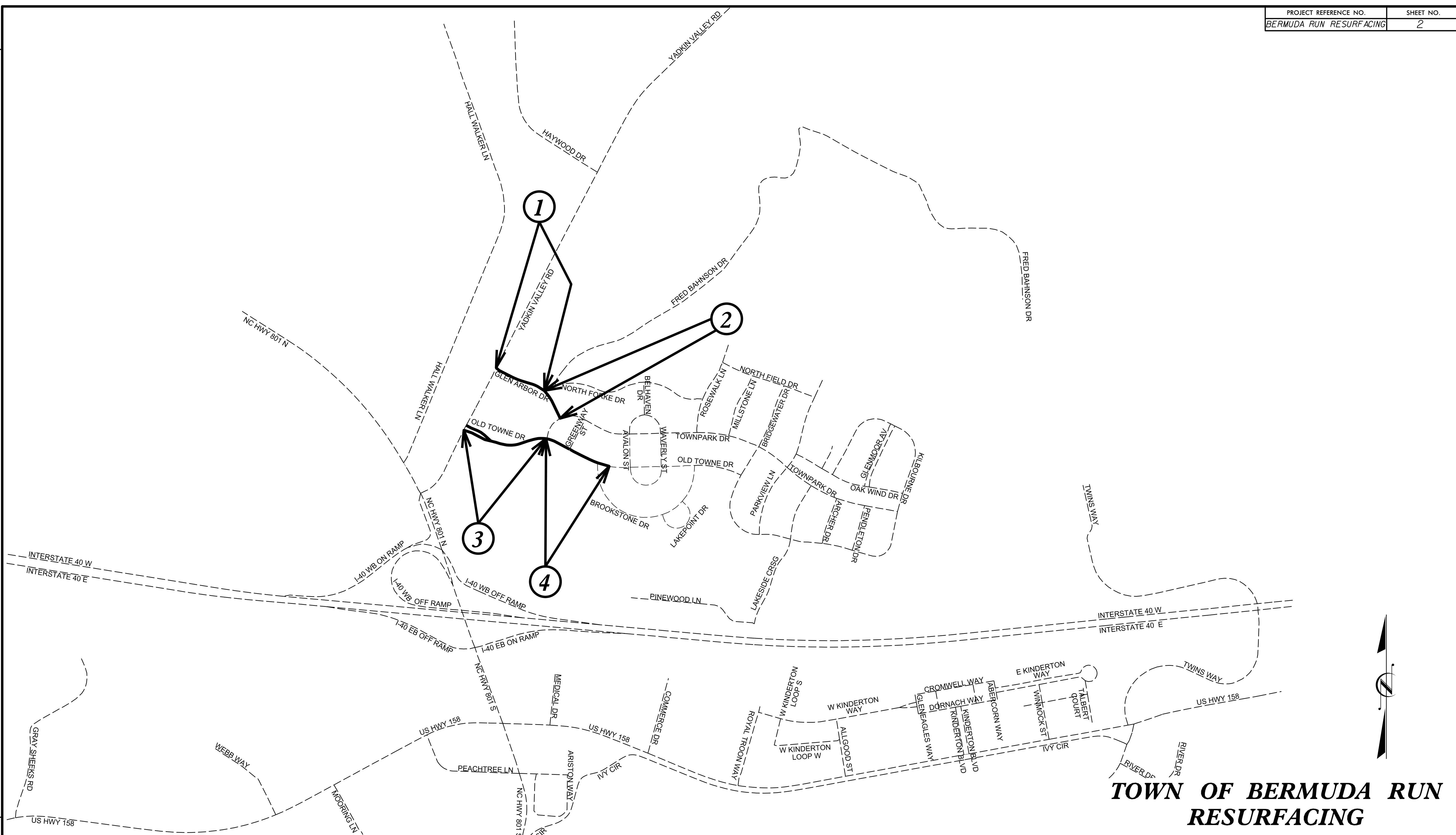

**TOWN OF BERMUDA RUN
RESURFACING**

MATCHLINE SHEET 3

- POWELL BILL STREETS**
- 1. GLEN ARBOR DRIVE**
 - 2. GLEN ARBOR DRIVE**
 - 3. OLD TOWNE DRIVE**
 - 4. OLD TOWNE DRIVE**

8/17/99

PAVEMENT SCHEDULE	
C1	PROP. APPROX. 1½" ASPHALT CONCRETE SURFACE COURSE, TYPE S9.5B, AT AN AVERAGE RATE OF 168 LBS. PER SQ. YD.
C2	PROP. APPROX. 2" ASPHALT CONCRETE SURFACE COURSE, TYPE S9.5B, AT AN AVERAGE RATE OF 224 LBS. PER SQ. YD.
V1	MILLING OF EXISTING ASPHALT PAVEMENT AT DEPTH OF 2"
T	SHOULDER RECONSTRUCTION
U	EXISTING PAVEMENT

PROJECT REFERENCE NO.	SHEET NO.
BERMUDA RUN RESURFACING	4

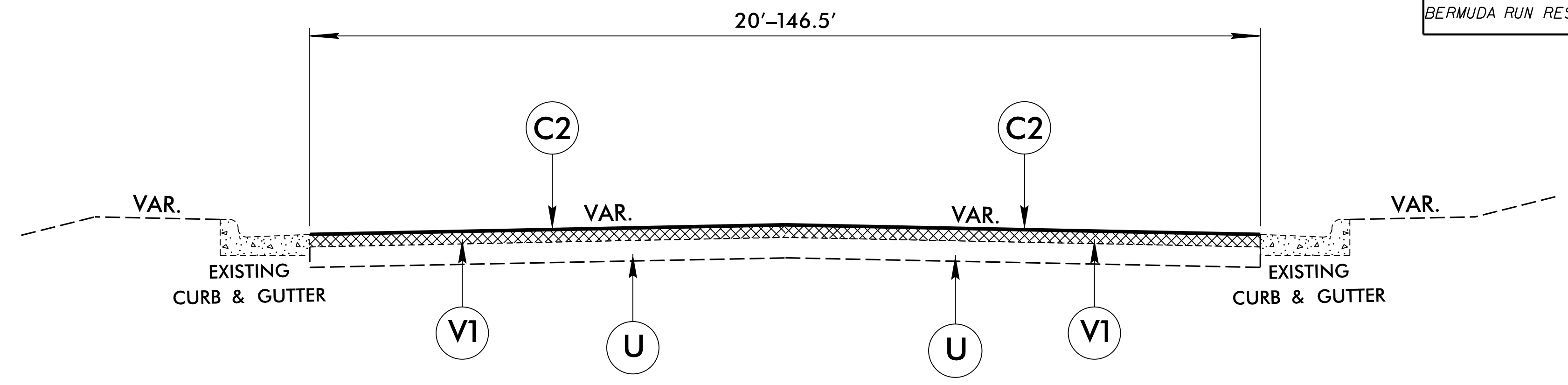

TYPICAL SECTION NO. 1

- MAP 1 – GLEN ARBOR DRIVE FROM ENTRANCE TO NORTH FORKE DRIVE – 0.08 MILES
- MAP 2 – GLEN ARBOR DRIVE FROM NORTH FORKE DRIVE TO TOWN PARK DRIVE – 0.06 MILES
- MAP 3 – OLD TOWN DRIVE FROM SHOPPING CENTER ENTRANCE TO TOWN PARK DRIVE – 0.14 MILES
- MAP 4 – OLD TOWN DRIVE FROM TOWN PARK DRIVE TO BROOKSTONE DRIVE – 0.13 MILES
- MAP 5 – BURMUDA VILLAGE DRIVE FROM BING CROSBY BOULEVARD TO HOLLYBROOK DRIVE – 0.05 MILES
- MAP 9 – BRIDGE STREET FROM BING CROSBY BOULEVARD TO JUNIPER CIRCLE 0.16 MILES
- MAP 10 – ORCHARD PARK DRIVE FROM NC 801 TO KNICKER LANE – 0.46 MILES

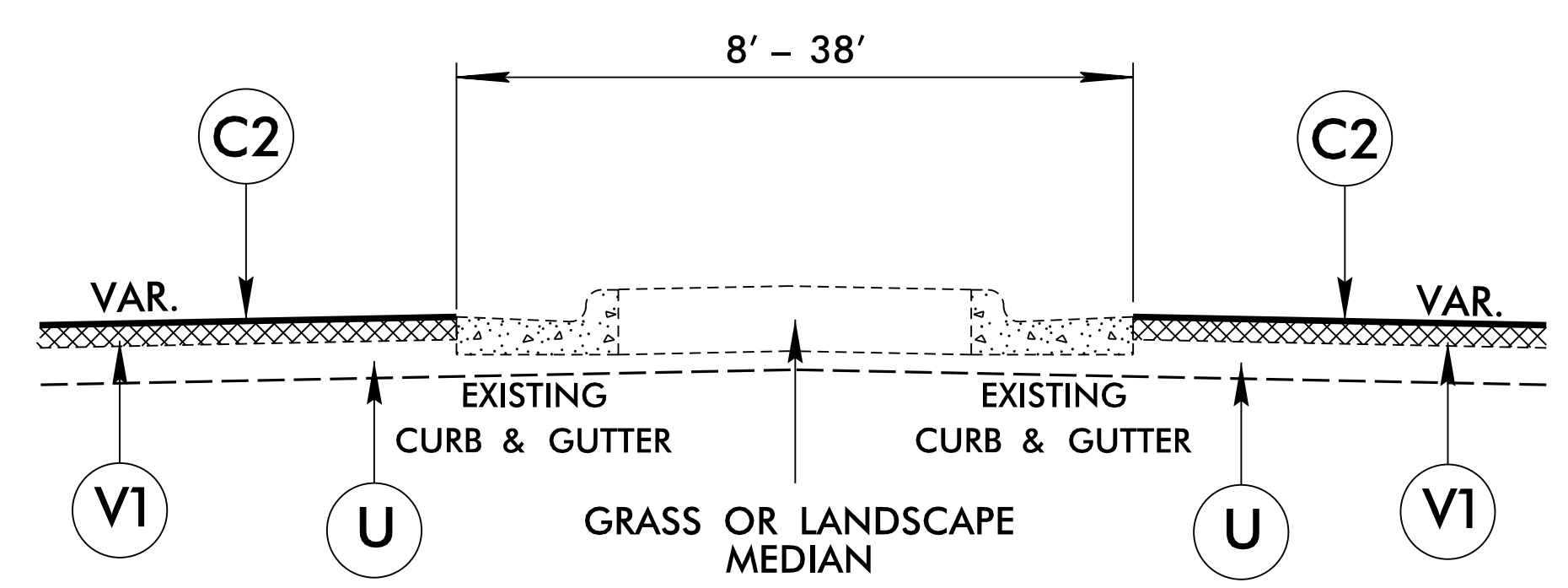

USE IN CONJUNCTION WITH TYPICAL SECTION NO. 1

- MAP 1 – GLEN ARBOR DRIVE
MEDIAN SECTION – 158' +/-
- MAP 3 – OLD TOWN DRIVE
MEDIAN SECTION – 226' +/-
- MAP 5 – BURMUDA VILLAGE DRIVE
MEDIAN SECTION – 87' +/-
- MAP 10 – ORCHARD PARK DRIVE
MEDIAN SECTION – 248' +/-

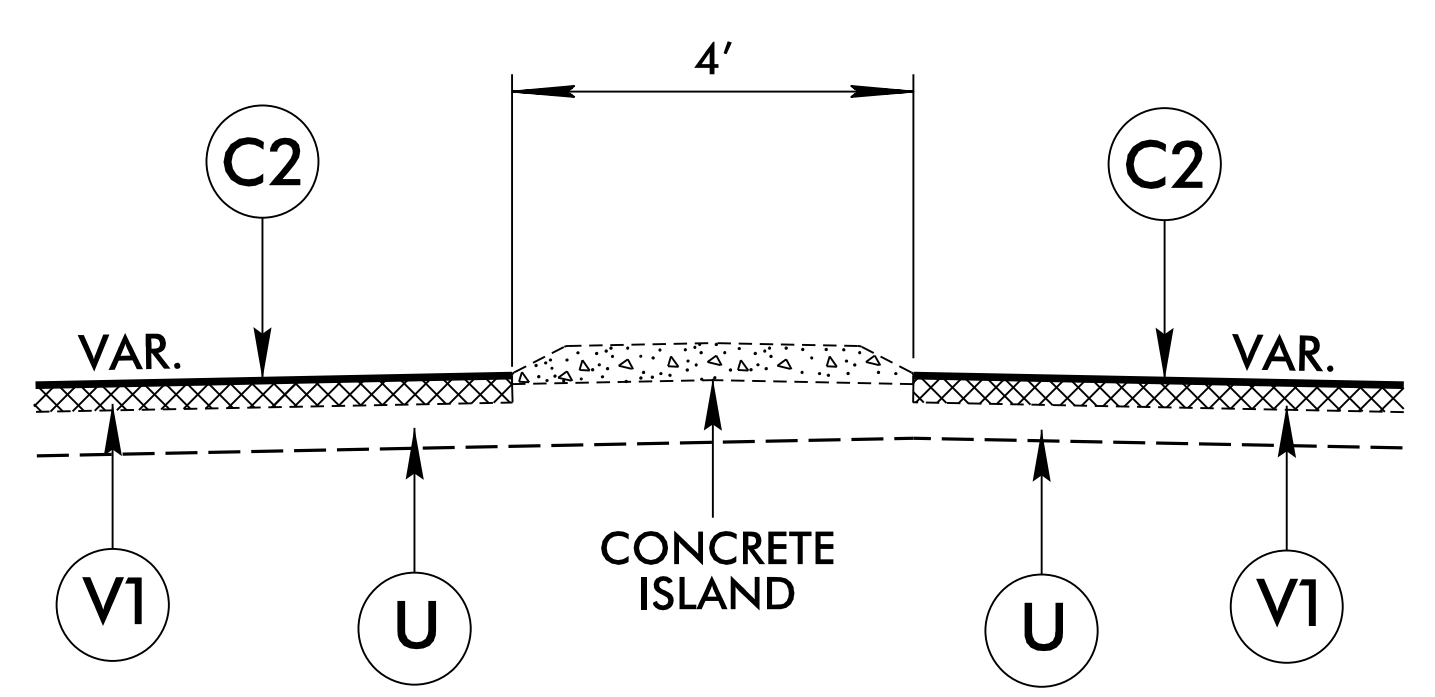

USE IN CONJUNCTION WITH TYPICAL SECTION NO. 1

- MAP 10 – ORCHARD PARK DRIVE
ISLAND SECTION – 57' +/-

B.17/99

PAVEMENT SCHEDULE	
C1	PROP. APPROX. 1½" ASPHALT CONCRETE SURFACE COURSE, TYPE S9.5B, AT AN AVERAGE RATE OF 168 LBS. PER SQ. YD.
C2	PROP. APPROX. 2" ASPHALT CONCRETE SURFACE COURSE, TYPE S9.5B, AT AN AVERAGE RATE OF 224 LBS. PER SQ. YD.
V1	MILLING OF EXISTING ASPHALT PAVEMENT AT DEPTH OF 2"
T	SHOULDER RECONSTRUCTION
U	EXISTING PAVEMENT

PROJECT REFERENCE NO.	SHEET NO.
BERMUDA RUN RESURFACING	5

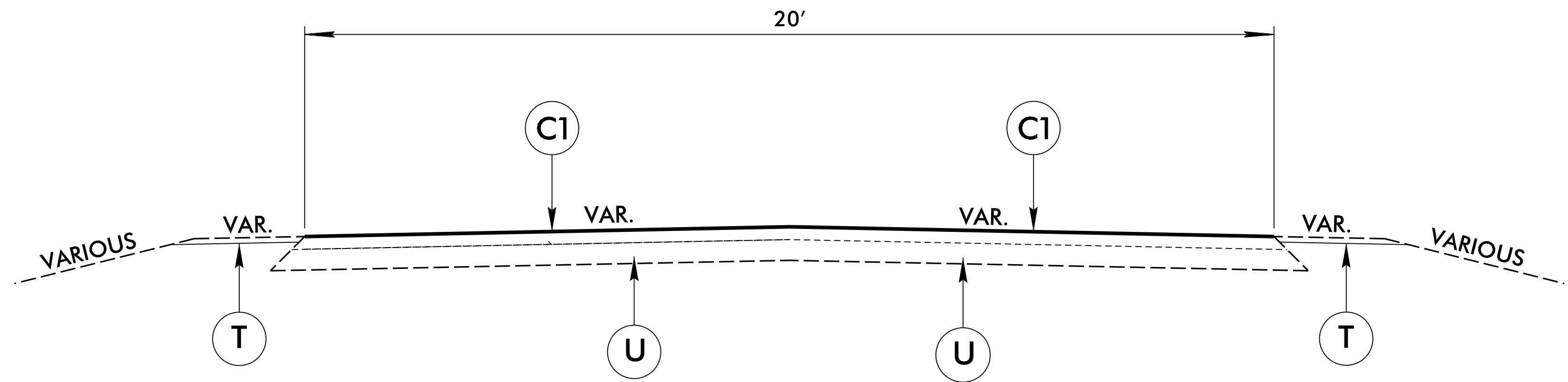

TYPICAL SECTION NO. 2

- MAP 6 – JUNIPER CIRCLE FROM BRIDGE STREET TO CUL-DE-SAC – 0.22 MILES
- MAP 7 – JUNIPER CIRCLE FROM W. RIVERBEND DRIVE TO BRIDGE STREET– 0.09 MILES
- MAP 8 – RIVERBEND DRIVE FROM W. RIVERBEND DRIVE TO BENT STREET – 0.66 MILES

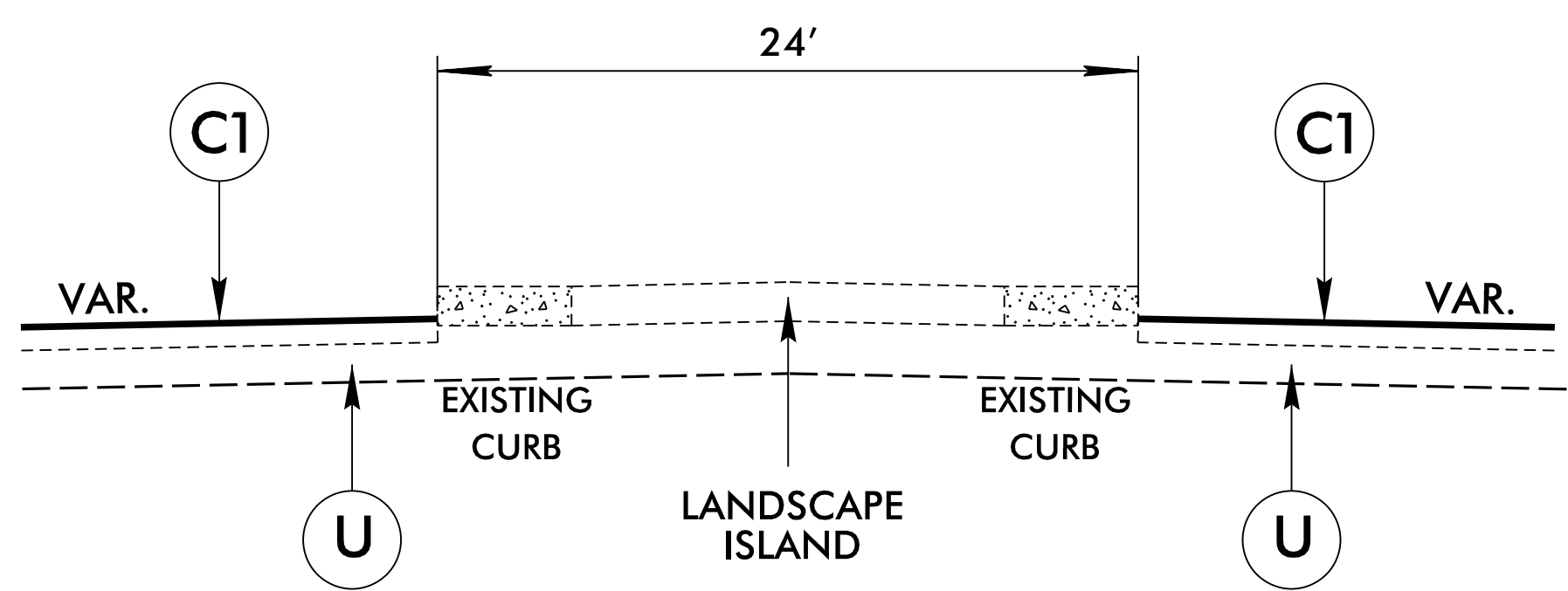

USE IN CONJUNCTION WITH TYPICAL SECTION NO. 2

MAP 6 – JUNIPER CIRCLE
ISLAND SECTION – 24' +/-

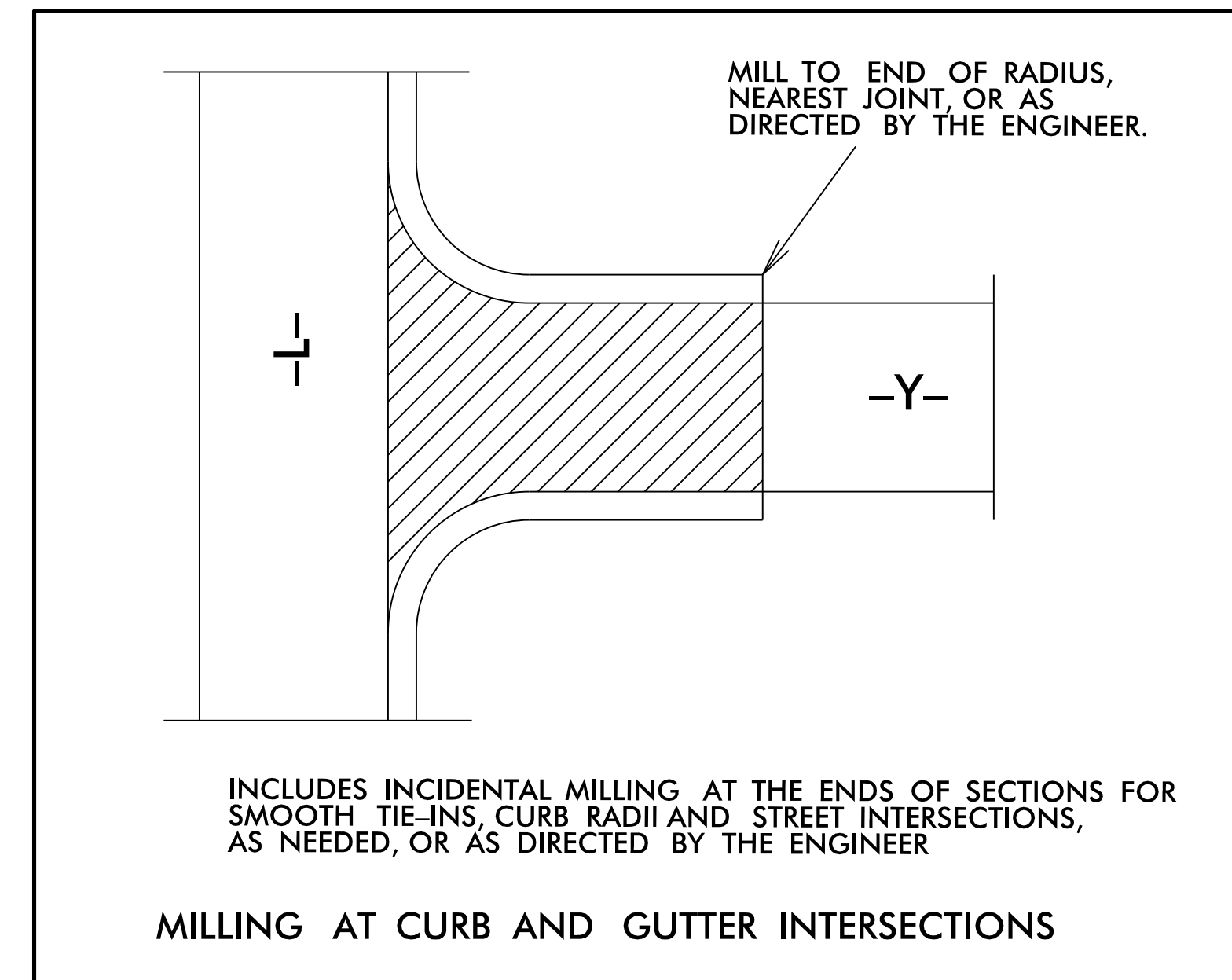
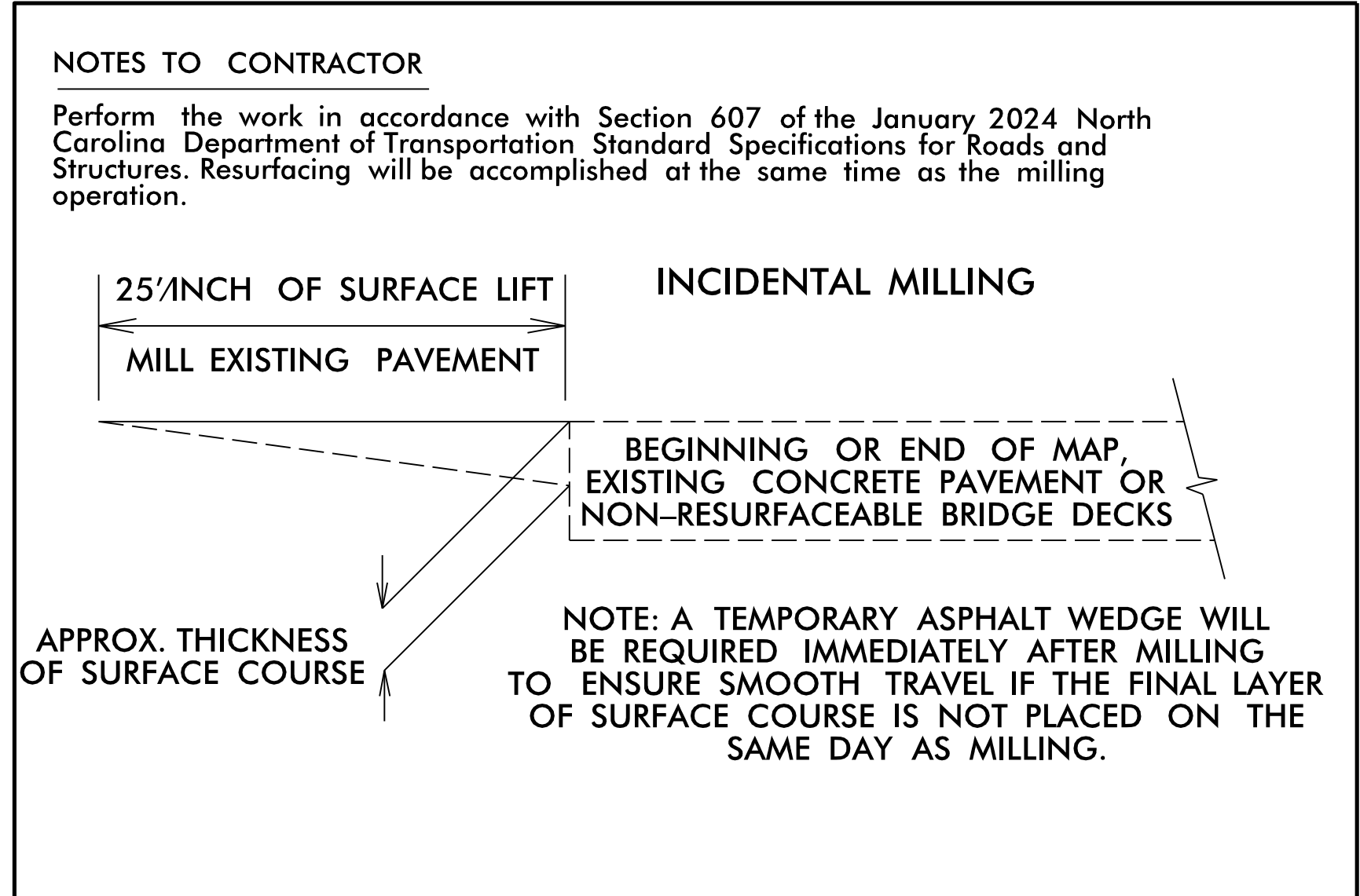
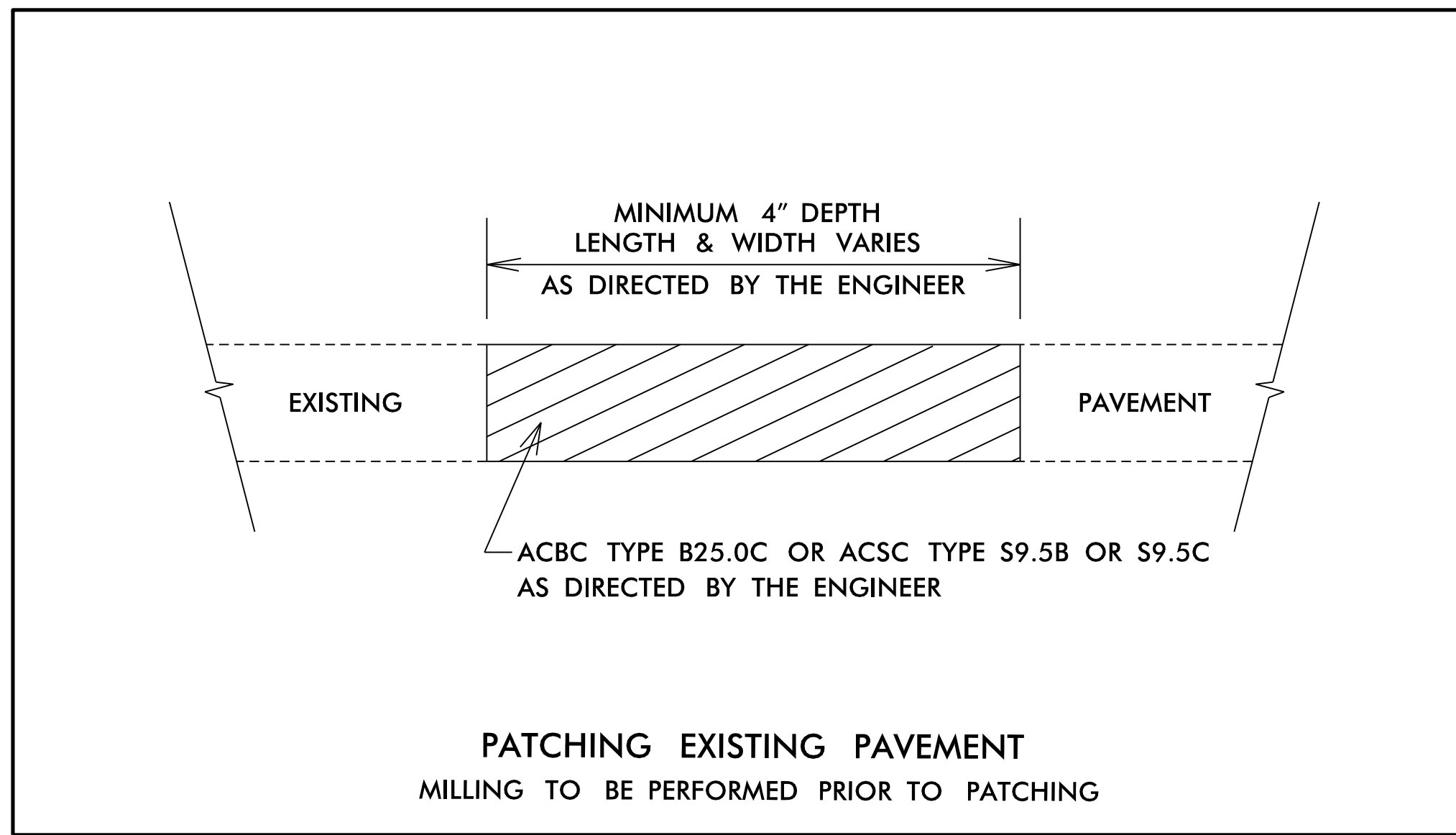

NOTES

1. ALL PAVED ROADS TO BE RESURFACED TO THE ENDS OF THE RADII, OR AS DIRECTED BY THE ENGINEER.

PROJECT NO.	SHEET NO.	TOTAL NO.
BERMUDA RUN	7	9

SUMMARY OF QUANTITIES

PROJECT NO	COUNTY	MAP NO	ROUTE	DESCRIPTION	TYP NO	LANES	LANE TYPE	LENGTH	WIDTH	BEGIN MP	END MP	1220000000-E	1231000000-E	1245000000-E	1297000000-E	1330000000-E	1519000000-E	1575000000-E	1704000000-E	6084000000-E	6090000000-E	6093000000-E	
								MI	FT			TONS	CY	SMI	SY	SY	TONS	TON	TONS	AC	LB	TON	
BERMUDA RUN	Davie	1	GLEN ARBOR DRIVE	FROM ENTRANCE TO NORTH FORK DRIVE	1	2	2WU	0.08	20	0	0.08				1,032	377	163	11					
TOTAL FOR MAP NO. 1								0.08							1,032	377	163	11					
BERMUDA RUN	Davie	2	GLEN ARBOR DRIVE	FROM NORTH FORKE DRIVE TO TOWN PARK DRIVE	1	2	2WU	0.06	20	0	0.06				661	130	92	6					
TOTAL FOR MAP NO. 2								0.06							661	130	92	6					
BERMUDA RUN	Davie	3	OLD TOWNE DRIVE	FROM SHOPPING CENTER ENTRANCE TO TOWN PARK DRIVE	1	2	2WU	0.14	20	0	0.14				2,556	512	355	23					
TOTAL FOR MAP NO. 3								0.14							2,556	512	355	23					
BERMUDA RUN	Davie	4	OLD TOWNE DRIVE	FROM TOWN PARK DRIVE TO BROOKSTONE DRIVE	1	2	2WU	0.13	20	0	0.13				1,014	705	199	13					
TOTAL FOR MAP NO. 4								0.13							1,014	705	199	13					
TOTAL POWELL BILL								0.41								5,263	1,724	809	53				
BERMUDA RUN	Davie	5	BERMUDA VILLAGE DRIVE	FROM BING CROSBY BOULEVARD TO HOLLYBROOK DRIVE	1	2	2WU	0.05	20	0	0.05				242	1,074	97	6					
TOTAL FOR MAP NO. 5								0.05							242	1,074	97	6					
BERMUDA RUN	Davie	6	JUIPER CIRCLE	FROM BRIDGE STREET TO CUL DE SAC	2	2	2WU	0.22	20	0	0.22	0.50	23.00	0.35			256	18	12	0.10	10	0.05	
TOTAL FOR MAP NO. 6								0.22				0.50	23.00	0.35			256	18	12	0.10	10	0.05	
BERMUDA RUN	Davie	7	JUNIPER CIRCLE	FROM W RIVERBEND DRIVE TO BRIDGE STREET	2	2	2WU	0.09	20	0	0.09	0.50	11.00	0.16		119	99	7	5	0.05	5	0.02	
TOTAL FOR MAP NO. 7								0.09				0.50	11.00	0.16		119	99	7	5	0.05	5	0.02	
BERMUDA RUN	Davie	8	RIVERBEND DRIVE	FROM W RIVERBEND DRIVE TO BENT STREET	2	2	2WU	0.66	20	0	0.66	0.50	68.00	1.03		454	699	50	35	0.35	35	0.18	
TOTAL FOR MAP NO. 8								0.66				0.50	68.00	1.03		454	699	50	35	0.35	35	0.18	
BERMUDA RUN	Davie	9	BRIDGE STREET	FROM BING CROSBY BLVD TO JUNIPER CIRCLE	1	2	2WU	0.16	20	0	0.16				1,998	57	238	15					
TOTAL FOR MAP NO. 9								0.16							1,998	57	238	15					
BERMUDA RUN	Davie	10	ORCHARD PARK DRIVE	FROM NC 801 TO KNICKER LANE	1	2	2WU	0.46	20	0	0.46				4,893	2,096	808	53					
TOTAL FOR MAP NO. 10								0.46							4,893	2,096	808	53					
TOTAL NON POWELL BILL								1.64				1.50	102.00	1.54	7,133	3,800	2,197	149	52	0.50	50	0.25	
PROJECT GRAND TOTAL								2.05				1.50	102.00	1.54	12,396	5,524	3,006	202	52	0.50	50	0.25	

PROJECT NO.	SHEET NO.	TOTAL NO.
BERMUDA RUN	8	9

THERMOPLASTIC AND PAINT QUANTITIES

PROJECT NO	COUNTY	MAP NO	ROUTE	DESCRIPTION	TYP NO	LANES	LANE TYPE	LENGTH	WIDTH	BEGIN MP	END MP	4413000000-E	4457000000-N	4810000000-E	4820000000-E	4835000000-E	4845000000-N	4845000000-N	4845000000-N
								MI	FT			WORK ZONE ADVANCE/GENERAL WARNING SIGNING	TEMPORARY TRAFFIC CONTROL	4" WHITE PAINT	8" WHITE PAINT	24" WHITE PAINT	PAINT RT ARROW	PAINT LT ARROW	PAINT STR & RT ARROW
												SF	LS	LF	LF	LF	EA	EA	EA
BERMUDA RUN	Davie	1	GLEN ARBOR DRIVE	FROM ENTRANCE TO NORTH FORK DRIVE	1	2	2WU	0.08	20	0	0.08	9	0.04	70		100	2	2	
TOTAL FOR MAP NO. 1								0.08				9	0.04	70		100	2	2	
BERMUDA RUN	Davie	2	GLEN ARBOR DRIVE	FROM NORTH FORKE DRIVE TO TOWN PARK DRIVE	1	2	2WU	0.06	20	0	0.06	7	0.03			50			
TOTAL FOR MAP NO. 2								0.06				7	0.03			50			
BERMUDA RUN	Davie	3	OLD TOWNE DRIVE	FROM SHOPPING CENTER ENTRANCE TO TOWN PARK DRIVE	1	2	2WU	0.14	20	0	0.14	16	0.07	110		90		2	2
TOTAL FOR MAP NO. 3								0.14				16	0.07	110		90		2	2
BERMUDA RUN	Davie	4	OLD TOWNE DRIVE	FROM TOWN PARK DRIVE TO BROOKSTONE DRIVE	1	2	2WU	0.13	20	0	0.13	15	0.06						
TOTAL FOR MAP NO. 4								0.13				15	0.06						
TOTAL POWELL BILL								0.41				47	0.20	180		240	2	4	2

BERMUDA RUN	Davie	5	BERMUDA VILLAGE DRIVE	FROM BING CROSBY BOULEVARD TO HOLLYBROOK DRIVE	1	2	2WU	0.05	20	0	0.05	6	0.02	60					
TOTAL FOR MAP NO. 5								0.05				6	0.02	60					
BERMUDA RUN	Davie	6	JUIPER CIRCLE	FROM BRIDGE STREET TO CUL DE SAC	2	2	2WU	0.22	20	0	0.22	25	0.11	2,330					
TOTAL FOR MAP NO. 6								0.22				25	0.11	2,330					
BERMUDA RUN	Davie	7	JUNIPER CIRCLE	FROM W RIVERBEND DRIVE TO BRIDGE STREET	2	2	2WU	0.09	20	0	0.09	10	0.04	750					
TOTAL FOR MAP NO. 7								0.09				10	0.04	750					
BERMUDA RUN	Davie	8	RIVERBEND DRIVE	FROM W RIVERBEND DRIVE TO BENT STREET	2	2	2WU	0.66	20	0	0.66	74	0.32	7,260	110				
TOTAL FOR MAP NO. 8								0.66				74	0.32	7,260	110				
BERMUDA RUN	Davie	9	BRIDGE STREET	FROM BING CROSBY BLVD TO JUNIPER CIRCLE	1	2	2WU	0.16	20	0	0.16	18	0.08	1,830	110				
TOTAL FOR MAP NO. 9								0.16				18	0.08	1,830	110				
BERMUDA RUN	Davie	10	ORCHARD PARK DRIVE	FROM NC 801 TO KNICKER LANE	1	2	2WU	0.46	20	0	0.46	52	0.22						
TOTAL FOR MAP NO. 10								0.46				52	0.226						
TOTAL FOR NON POWELL BILL								1.64				185	0.801	12,230	220				
PROJECT GRAND TOTAL								2.05				232	1.000	12,410	220	240	2	4	2

SIGNING FOR RESURFACING PROJECTS

LEGEND

┆ STATIONARY SIGN

← DIRECTION OF TRAFFIC FLOW

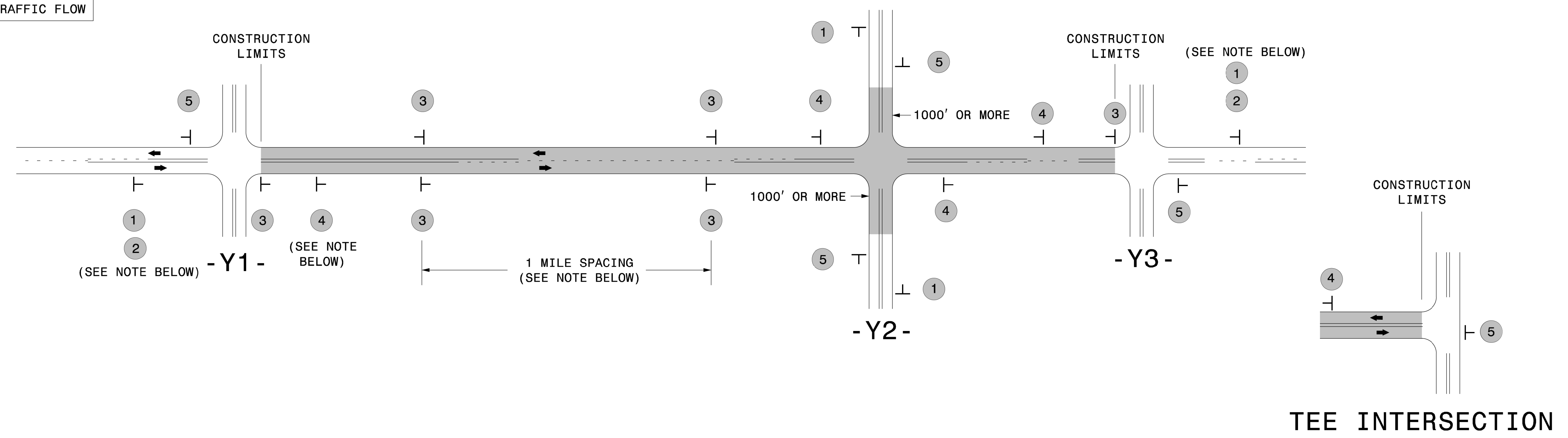

MAINLINE (-L-) SIGNING

-Y- LINE SIGNING

SIGNING NOTES AND PLACEMENT PER DIRECTION	1	 W20-1 48" X 48"	PLACE 1000' PRIOR TO BEGINNING OF CONSTRUCTION LIMITS. ONLY USED ON -Y- LINES IF RESURFACING LIMITS EXTEND 1000' ALONG -Y- LINE.	NO REQUIRED STATIONARY SIGNING FOR THE FOLLOWING -Y- LINE CONDITIONS: 1) LESS THAN 1000' OF RESURFACING ALONG -Y- LINE 2) SUBDIVISION ROADS 3) DEAD END ROADS WHEN PAVING/CONSTRUCTION ACTIVITIES PROCEED ACROSS AN UNSIGNED -Y- LINE, PORTABLE ADVANCE WARNING SIGNS SHALL BE USED ALONG THE -Y- LINE AS SHOWN BELOW. REMOVE UPON COMPLETION OF WORK.		
	2	 W7-3aP 24" X 18"	#2 SIGN ONLY USED WHEN CONSTRUCTION LIMITS ARE 2 OR MORE MILES IN LENGTH. ROUND UP TO NEXT WHOLE NUMBER. (NO FRACTIONAL OR DECIMAL NUMBERS)			
	3	 SP 13107 48" X 48"	- PLACE INITIALLY AT THE CONSTRUCTION LIMITS AND SPACE 1 MILE APART THEREAFTER. - AT TEE INTERSECTIONS INSTALL INITIALLY 1/2 MILE FROM INTERSECTION AND SPACE 1 MILE APART THEREAFTER.			
	4	 SP 13106 48" X 48"	- THESE ARE FOR -Y- LINES THAT ARE "THROUGH" ROADWAYS. - DEAD END AND SUBDIVISION ROADS ARE NOT "THROUGH" ROADWAYS. - INSTALL 500' +/- FROM EACH -Y- LINE APPROACH AS SHOWN ABOVE. - FOR MULTIPLE -Y- LINES THAT ARE SEPARATED BY 0.25 MILES OR LESS, TREAT AS A SINGLE UNIT AND INSTALL WITHIN 500' OF EACH APPROACH. - A MAXIMUM OF 2 SIGN SETS PER MILE. DO NOT INSTALL WHEN -Y- LINES ARE WITHIN 0.5 MILES FROM "END ROAD WORK" SIGN. - FOR TEE INTERSECTIONS, INSTALL WITHIN 500' +/- OF THE INTERSECTION ALONG -L- LINE.		 W20-1 48" X 48" PLACED 500' IN ADVANCE OF FLAGGER.	 W20-7 A 48" X 48" PLACED 250' IN ADVANCE OF FLAGGER.
	5	 G20-2 A 48" X 24"	PLACE 500' FOLLOWING THE END OF CONSTRUCTION LIMITS OR AS SHOWN WHEN WORK ENDS AT A 3-WAY TEE INTERSECTION.			

MAPS LESS THAN 2 MILES

THE ABOVE SIGNS ARE ALL THAT ARE REQUIRED FOR A CONTRACTOR TO BEGIN A RESURFACING CONTRACT. ANY ADDITIONAL SIGNS REQUESTED BY NCDOT DIVISIONS SHALL BE INSTALLED WITHIN 7 BUSINESS DAYS OF THE START OF CONTRACT WORK.

FOR RESURFACING MAPS WITH CONSTRUCTION LIMITS LESS THAN 2 MILES IN LENGTH, NO STATIONARY SIGNS ARE REQUIRED. USE PORTABLE "ROAD UNDER CONSTRUCTION" OR "ROAD WORK AHEAD" SIGNS IN LIEU OF STATIONARY ADVANCE WARNINGS SIGNS.



ADVANCE WARNING SIGNS FOR RURAL AND SUBURBAN 2-LANE ROADWAY RESURFACING

5/15/2017 S:\TMD\WZTC\Resurfacing\2L2W & AST Resurfacing Details\ResurfacingAdvWarn_2Ln.dgn User:keckalis